

# XR150/XR350/XR550

## USER'S GUIDE



## **Silencing an Alarm**

When the alarm bell or siren is sounding, enter your user code or present your card to a keypad or reader during the Status List display.

**All/Perimeter, Home/Sleep/Away, or Home/Sleep/Away with Guest System**

IS THIS A FALSE ALARM? or CANCEL VERIFY displays.

- If a burglar alarm is valid, press NO or VERIFY to send a verification message to the Central Station.
- If a valid alarm has not occurred, press YES or CANCEL to cancel the alarm and send an Abort or Cancel message to the Central Station and the security system will be disarmed.

© 2013 Digital Monitoring Products, Inc.

Information furnished by DMP is believed to be accurate and reliable.

This information is subject to change without notice.

# User Guide

## for XR150/XR350/XR550 Series Panels

### Table of Contents

| <i>Section</i>                            | <i>Page</i> | <i>Section</i>   | <i>Page</i> |
|---|-------------|--|-------------|
| <b>Introduction</b> .....                 | <b>1</b>    | Area System Disarming Operation .....                                    | 17          |
| XR150, XR350, and XR550 Systems .....     | 1           | All/Perimeter System Arming .....  | 18          |
| About Your Security System .....          | 1           | All/Perimeter System Disarming .....                                     | 19          |
| Emergency Evacuation Plans .....          | 2           | Home/Sleep/Away and Home/Sleep/Away<br>with Guest System Arming .....    | 20          |
| DMP Keypads .....                         | 3           | Home/Sleep/Away and Home/Sleep/Away<br>with Guest System Disarming ..... | 21          |
| The Select keys .....                     | 4           | Extending Schedules .....  | 22          |
| Power/Armed LED .....                     | 4           | Keypad Shortcut Keys .....   | 22          |
| Power/Armed Logo .....                    | 5           | <b>User Menu</b> .....   | <b>23</b>   |
| Panic Functions .....                     | 5           | Accessing the User Menu .....  | 23          |
| 7/0 Panic Function .....                  | 6           | User Menu Options .....  | 23          |
| Common Keys on All Keypads .....          | 6           | Alarm Silence .....  | 25          |
| Using the Keypad .....                    | 6           | Sensor Reset .....   | 25          |
| Keypad User Options .....                 | 7           | Lockdown .....   | 25          |
| Special Keypad Tones .....                | 8           | Door Lock/Unlock .....   | 26          |
| DMP Wireless .....                        | 9           | Door Access .....  | 26          |
| Special Wireless Displays .....           | 9           | Armed Areas Display .....  | 26          |
| Special Keypad Displays .....             | 10          | Outputs On Off .....   | 26          |
| Cell Phone Messages .....                 | 11          | Favorite .....   | 27          |
| MyAccess™ Text Messaging Commands .....   | 11          | Z-Wave Setup .....   | 28          |
| Understanding Security System Terms ..... | 11          | Zone Status .....  | 33          |
| <b>Arming and Disarming</b> .....         | <b>14</b>   | Bypass Zones .....   | 34          |
| General Arming Operation .....            | 14          | Zone Monitor .....   | 34          |
| Key Fob Arming .....                      | 15          | System Status .....  | 35          |
| Key Fob Disarming .....                   | 16          | System Test .....  | 36          |
| Area System Arming Operation .....        | 16          |  |             |

|   |           |
|---|-----------|
| User Profiles .....                       | 37        |
| User Profiles Chart.....                  | 41        |
| User Codes .....                          | 42        |
| Forgive Failure to Exit.....              | 44        |
| Ambush Code .....                         | 45        |
| Extend Closing .....                      | 45        |
| Schedules.....                            | 45        |
| Setting Schedules.....                    | 46        |
| Setting Holiday Dates (HOL) .....         | 48        |
| Favorites.....                            | 48        |
| Display Events .....                      | 49        |
| Service Request .....                     | 49        |
| Fire Drill .....                          | 50        |
| System Setup Record .....                 | 51        |
| <b>System Setup .....</b>                 | <b>51</b> |
| Key Fob Button Programming.....           | 52        |
| Area Names and Numbers Record .....       | 53        |
| Z-Wave Device Name.....                   | 54        |
| Z-Wave Favorites List.....                | 55        |
| User Profiles Record .....                | 56        |
| User Codes Record .....                   | 57        |
| Schedules Record.....                     | 58        |
| Holiday Date Record.....                  | 59        |
| Output Record .....                       | 59        |
| About the Display Events Section.....     | 60        |
| Arming and Disarming Event Displays ..... | 61        |
| Zone Event Displays .....                 | 61        |
| Supervisory Event Displays .....          | 61        |
| User Code Change Event Displays .....     | 61        |
| Zone Bypass Event Displays .....          | 61        |

|   |           |
|---|-----------|
| <b>Appendix A .....</b>                     | <b>61</b> |
| Door Access Event Displays.....             | 62        |
| System Monitor Event Displays.....          | 63        |
| Schedule Change Event Displays .....        | 63        |
| Wireless Jamming Event Displays .....       | 64        |
| Wireless Trouble Event Displays.....        | 64        |
| <b>Appendix B .....</b>                     | <b>65</b> |
| Zone Status Browser .....                   | 65        |
| Bypass Zones Browser .....                  | 65        |
| Zone Monitor Browser.....                   | 66        |
| Add User Codes Browser.....                 | 66        |
| Change User Codes Browser .....             | 67        |
| Delete User Codes Browser .....             | 67        |
| Add User Profiles Browser .....             | 68        |
| Change User Profiles Browser.....           | 68        |
| Delete User Profiles Browser .....          | 69        |
| Output Groups Browser .....                 | 69        |
| <b>Appendix C .....</b>                     | <b>69</b> |
| <b>Appendix D .....</b>                     | <b>70</b> |
| Outputs On/Off Browser .....                | 70        |
| User Disarm and Entry.....                  | 70        |
| Entering User Names .....                   | 71        |
| <b>Appendix E.....</b>                      | <b>71</b> |
| Easy Entry™ User's Guide .....              | 73        |
| <b>Appendix F.....</b>                      | <b>74</b> |
| Email/Cell Phone Message User's Guide ..... | 74        |
| MyAccess™ Text Messaging Commands .....     | 76        |
| Subscribe to Text Messages .....            | 79        |
| Frequently Asked Questions .....            | 80        |
| Common Keypad Displays.....                 | 81        |

# Introduction

## XR150, XR350, and XR550 Systems

This Guide covers operation of the XR150, XR350, and XR550 Series systems.

## About Your Security System

The system has been designed with your safety and comfort in mind. It uses the latest in computer based technology to create the most advanced, user friendly security, fire, and access control system available.

The system combines ease of use with a simple to understand DMP keypad to offer the full range of features requested by today's security system owners.

Use the system to turn portions of your protection on or off by pressing a few keys, or have the system turn on or off automatically by entering a simple schedule. You can add, delete, and change personal user codes at any time or check the status of protection devices in the system.

## Parts of the System

There are two main parts to the security system, the keypad and the keypad User Menu.

## LCD Keypad

This is the device we have placed at certain locations throughout the premises that allow you to turn the system protection on and off using your personal user code.

## Keypad User Menu

The keypad provides a simple User Menu containing all of the functions you need to fully operate your system such as changing the time of day or a personal user code.

## A Note About False Alarms

One of the most important concerns facing the security industry today is false alarms. The accidental dispatching of police and fire agencies places others in jeopardy by limiting the response capability of those emergency service units.

As part of our commitment to reducing false alarms, we would like to encourage you to read this guide thoroughly. All the information contained here can help you quickly, and comfortably, learn the system operation. If you have any additional questions, or feel that you need more training, please do not hesitate to contact your alarm dealer.

**Note:** There may be a 30-second alarm communication delay pre-programmed at installation to allow disarming if a false alarm occurs. This delay is optional and can be removed or increased to 45 seconds by your alarm dealer.

## Test Your System Weekly

It is recommended that you test the burglary portion of your system at least once each week. Testing should involve an active test of all doors, windows, and motion detectors connected to your system. If your system also has fire protection, call the service department to find out how this portion of your system should be tested.

Refer to the System Test section of this guide for instructions on testing the burglary portion of your system and refer to the Fire Drill section for instructions on testing your system fire bells.

## Emergency Evacuation Plans

The National Fire Protection Association recommends that you establish an emergency evacuation plan to safeguard lives in the event of a fire or other emergency.

### Draw a Floor Plan of Your Home or Business

On a clean sheet of paper, draw the walls, windows, doors, and stairs. Also draw any obstacles that a person may encounter while exiting the building such as large furniture or appliances.

### Develop Escape Routes

Determine at least two routes the occupants in each room can take to safely escape. One route can be the most obvious such as the door. Another can be through a window that can be easily opened. If the window is high off the ground, an escape ladder should be provided.

Draw arrows on the floor plan to show escape routes from each room.

### Decide Where to Meet

Prewrite a meeting place outside and away from where emergency personnel are likely to be working. A neighbor's house or across the street in front of the house are good locations. Always perform a head count to make sure all occupants safely exited. NEVER ENTER A BURNING BUILDING. If the head count shows one or more persons missing, give this information immediately to the authorities. Never enter a building to look for someone.

### Practice Your Escape Plans

Devising an escape plan is only the beginning. For the plan to be effective everyone should practice escape routes from each room.

## Early Detection

The best way to survive a fire or other emergency is to get out early. The installation of a fire alarm system, with smoke and carbon monoxide detectors in each room, can greatly decrease your risk of loss or injury.

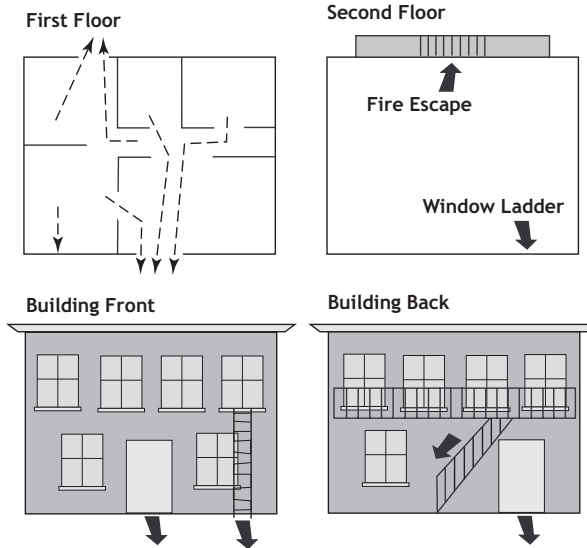

## DMP Keypads

Your system may have one or more easy to use LCD keypads that allow you to properly operate the system.

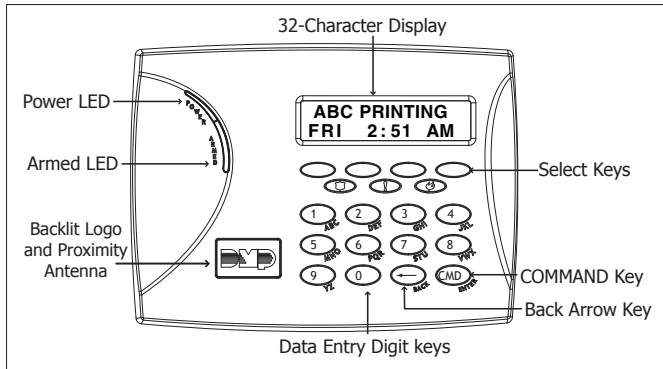

**Thinline™/Aqualite™ Keypad**

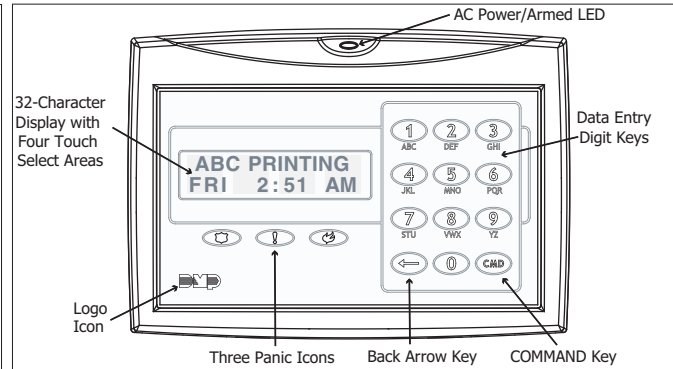

**Clear Touch™ Keypad**

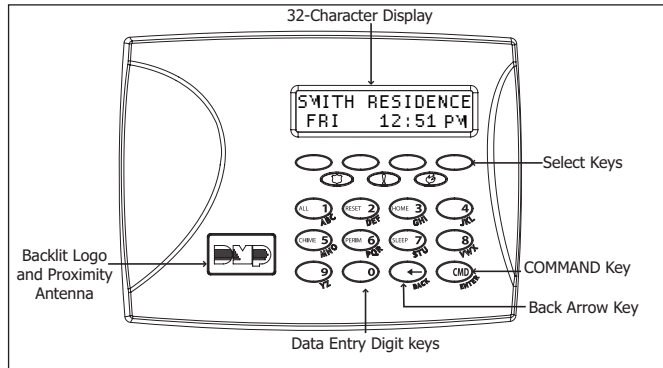

**Thinline™ Wireless Keypad**

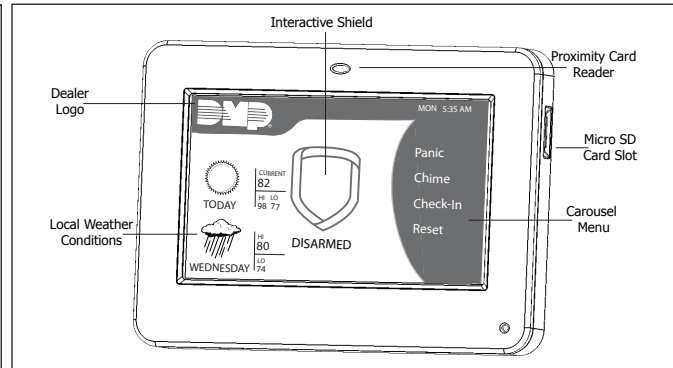

**Graphic Touchscreen Keypad**

## The Select keys

### Thinline™, Aqualite™ and Wireless Keypads:

There are four keys under the display called the Select keys. These keys are one of the features that make your system so easy to operate. They allow you to make selections by pressing the Select key under a choice shown in the display.

**Note:** For the purposes of this guide, when instructed to press the first Select key, press the far left Select key; the second Select key is the second from the left; third Select key is second from the right; and the fourth Select key is the far right key.

### Clear Touch™ and Graphic Touchscreen Keypads:

There are four Select Areas in the display. These Select Areas are one of the features that make your system so easy to operate. They allow you to make selections by touching the area to choose the item in the display.

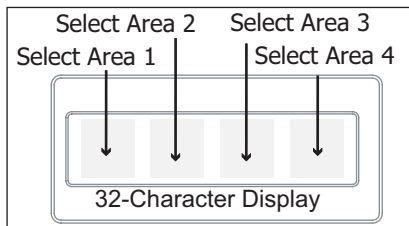

Clear Touch/Graphic Touchscreen Select Areas

**Note:** For the purposes of this guide when using Clear Touch™ or Graphic Touchscreen Keypads, when instructed to press the first Select key, touch Select Area 1; the second Select key touch Select Area 2; third Select key touch Select Area 3; and the fourth Select key touch Select Area 4.

## Power/Armed LED

### Thinline™ and Aqualite™ Keypads:

The Power LED indicates the panel Power status. It is recommended you contact the service department when the Power LED is off or blinks.

| LED Operation | AC      | Battery |
|---------------|---------|---------|
| ON (Steady)   | OK      | OK      |
| OFF           | Trouble | N/A     |
| BLINKS        | OK      | Trouble |

The Armed LED is ON steady anytime any burglary protection area is armed and is OFF when ALL areas are disarmed.

### Clear Touch™ and Graphic Touchscreen Keypads:

The LED indicates the Power and Armed status of the panel. Depending on the operation, the LED displays in Red or Blue as listed in the table.

| Color and Activity | LED Operation                              |
|--------------------|--|
| Blue Steady        | Panel Disarmed, AC Power OK, Battery OK    |
| Blue Blinking      | Panel Disarmed, AC Power OK, Battery Fault |
| No Light           | Panel Disarmed, AC Power Fault, Battery OK |
| Red Steady         | Panel Armed, AC Power OK, Battery OK       |
| Red/Blue Alternate | Panel Armed, AC Power OK, Battery Fault    |
| Red Blinking       | Panel Armed, AC Power Fault, Battery OK    |



## Power/Armed Logo

### Thinline™ Wireless Keypads:

The backlit logo on the keypad indicates the panel armed status and the keypad power status. Depending on the operation, the logo displays Red or Green as listed in the table.

| Color and Activity  | Armed Status   | Keypad Power Status        |
|---------------------|----------------|----------------------------|
| Green Steady        | Panel Disarmed | AC Power OK, Battery OK    |
| Green Blinking      | Panel Disarmed | AC Power OK, Battery Fault |
| No Light            | Panel Disarmed | AC Power Fault, Battery OK |
| Red Steady          | Panel Armed    | AC Power OK, Battery OK    |
| Red/Green Alternate | Panel Armed    | AC Power OK, Battery Fault |
| Red Blinking        | Panel Armed    | AC Power Fault, Battery OK |

## Panic Functions

Your keypad may be set up to send a Panic, Emergency, or Fire report to the central station. This function is optional. If this option is programmed for your keypad, icons display below the top row Select keys/areas.

### Thinline™, Aqualite™ and Wireless Keypads:

Press and hold the two Select keys adjacent to the desired icon for 2 seconds, until a beep from the keypad is heard.

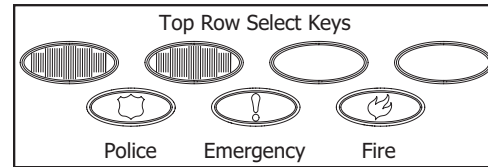

### Thinline™/Aqualite™/Thinline™ Icon Keypad Panic Keys With Shaded Buttons To Indicate Police Panic Keys

### Clear Touch™ and Graphic Touchscreen Keypads:

Touch the icon for 2 seconds until a beep is heard.

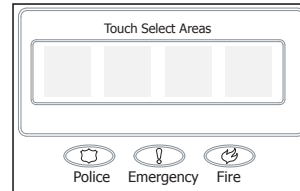

Clear Touch™ Keypad Panic Icons    Graphic Touchscreen Panic Icons

## 7/0 Panic Function

### Thinline™ and Aqualite™ Keypads:

Thinline™ and Aqualite™ Keypads may also be programmed at installation to allow the user to initiate an optional Panic alarm by simultaneously pressing and holding the 7 and 0 (zero) keys. When the 7 and 0 keys are pressed for a short time, the keypad sends a Panic alarm report to the central station.

**Note:** The 7/0 Panic Function is not available on Clear Touch™, Thinline™ Icon, Wireless, or Graphic Touchscreen keypads.

## Common Keys on All Keypads

### Data Entry Digit keys

These keys allow you to enter your user code when arming or disarming or enter other information into the system.

### COMMAND (CMD) key

The COMMAND key allows you to advance through the keypad displays, User Menu, or complete a data entry function.

### Back Arrow (←) key

The Back Arrow (←) key is used to go back through the keypad displays while operating your system. You can press the Back Arrow key to back up through the list of functions in the User Menu or to erase the last character you entered.

## Using the Keypad

### Multi-lingual Display Option

Your system may be programmed to display the User Menu and Status Display text in multiple languages. When the COMMAND key is pressed, the option to choose the language displays. Select the language you want to use. The language chosen continues to display at this keypad until another language is chosen.

### Keypad Displays Current Programming

Most User Menu options displayed at the keypad show the currently selected option in the panel memory. These options are either shown as a number, a blank, or a **NO** or **YES**. To change a number press any top row Select key. The current option is replaced with a dash. Press the number(s) on the keypad you want to enter as the new number for that option.

It is not necessary to enter numbers with leading zeros. The panel automatically right justifies when you press the COMMAND key. To change an option that requires a **NO** or **YES** response, press the top row Select key for the response not selected. For example, if the current option is **YES** and you want to change it to **NO**, press the third Select key. The display changes to **NO**. Press the COMMAND key to go to the next option.

### Multiple Displays (XR350 and XR550 System Only)

For some User Menu options, such as **Access Areas** under **User Profiles** there are several displays containing lists. For example, when using **Access Areas**, areas 1 through 32 display on four separate displays. First, areas 1 through 8 display. Press the COMMAND key to display areas 9 through 16. Press the COMMAND key again to display areas 17 through 25. Press the COMMAND key one more time to display areas 26 through 32.

**Note:** Only areas pre-programmed at installation can be viewed.

## Asterisks in Area Armed Displays

Asterisks display next to a programming option that is already selected. As shown in the example, options that are selected to display the current programming selection have an asterisk next to the number. Those that are not selected simply display the number. In the Areas example, areas 3, 8, 9, 15, 19, 23, 25, and 31 are not selected. The area numbers with asterisks are selected.

| Areas |     |     |     |     |     |     |     |
|-------|-----|-----|-----|-----|-----|-----|-----|
| *1    | *2  | 3   | *4  | *17 | *18 | 19  | *20 |
| *5    | *6  | *7  | 8   | *21 | *22 | 23  | *24 |
| 9     | *10 | *11 | *12 | 25  | *26 | *27 | *28 |
| *13   | *14 | 15  | *16 | *29 | *30 | 31  | *32 |

To select or deselect a number, simply enter the number using the digit keys on the keypad. This same scheme is used when viewing the panel armed status and other programming and operational functions. Remember to press the COMMAND key to display the rest of the area numbers on XR550 systems.

**Note:** XR150 Systems support 8 areas.

## 32-Character Name Display

Your system may be programmed to display up to 32-character names. When a name is displayed at the keypad, the top line of the display shows the first 16 characters. If a name is longer than 16 characters, after two seconds the display automatically scrolls to display the remaining characters.

If displayed as part of the Status List, the entire 32-character name is displayed for four seconds followed by the number and status.

## Keypad User Options

The User Options allow you to make adjustments to your keypad to best fit your environment and needs.

**Thinline™, Aqualite™ and Wireless keypads:** Press and hold the Back Arrow and COMMAND keys for two seconds. The keypad display changes to SET BRIGHTNESS. Press the COMMAND key to display the next option or the Back Arrow key to exit.

**Clear Touch™ keypads:** Touch and hold the center of the logo icon for two seconds. The display changes to SET BRIGHTNESS. Touch the COMMAND (CMD) key to display the next option or touch the Back Arrow (←) to exit the User Options function.

**On Graphic Touchscreen keypads:** Pressing OPTIONS on the carousel until it glows displays the Setting Options screen. You may adjust the Screen Brightness by pressing the arrows at either end of the bar indicators.

## Backlighting Brightness

At the SET BRIGHTNESS display, use the left Select key to lower the keypad brightness. Use the right Select key to increase the brightness.

**Note:** If the brightness level is lowered, it temporarily reverts back to maximum intensity whenever a key is pressed.

**Thinline™ or Aqualite™ keypads:** This sets the LCD display, AC LED, and the Green or Blue keyboard backlighting brightness level.

**Wireless keypads:** This sets the LCD display, keyboard, and logo backlighting brightness level.

**Clear Touch™ Keypads:** The user selected brightness may be set to off which allows the glass graphic display to turn off (clear glass). Simply touch the glass anywhere and the backlight illuminates for data entry. When the speaker is sounding, the backlight illuminates at one-half (1/2) brightness.

**Graphic Touchscreen Keypads:** Set the backlight illumination and AC Power/Armed LED brightness level. In the touchscreen display below SET BRIGHTNESS, press the left < to lower and the right > to raise the backlight brightness. If the brightness level is lowered, it reverts to maximum intensity whenever the screen is pressed during normal operation. If the screen is not pressed, and the speaker has not sounded for 30 seconds, the user-selected standby brightness level restores.

### **Internal Speaker Tone**

Set the tone of the keypad internal speaker. At the SET TONE display, use the top left Select key to make the tone lower. Use the right Select key to make the tone higher.

### **Volume level**

Set the volume level of the keypad internal speaker for key presses. During alarm, trouble, and prewarn conditions, the volume is always at maximum level. At SET VOLUME LEVEL, use the left Select key to lower the keypad volume. Use the right Select key to raise the volume.

### **Model Number**

**Thinline™, Aqualite™, Wireless, Clear Touch, and Graphic Touchscreen Keypads:**

The keypad model number, firmware version, and date display, but cannot be changed.

### **Serial Number**

**Thinline™ Wireless Keypads:**

The serial number assigned to the keypad displays. Press the Back Arrow key to exit the User Options function.

### **Keypad Address**

The current address assigned to the keypad displays, but cannot be changed. Press the Back Arrow key to exit the User Options function.

## **Special Keypad Tones**

Your keypad also contains a small speaker that alerts you about events as they occur on your system. For burglary alarms, as soon as the first digit key is pressed to enter a user code, the keypad tone stops. If a valid user code is not entered or an invalid user code is entered within five seconds, the tone begins sounding again. Below are brief descriptions of the different tones you hear from the keypad.

**Fire Alarm tone:** A sweeping siren that sounds until the fire alarm is silenced.

**Burglary Alarm tone:** A constant siren tone that continues until the alarm is silenced.

**Key press tone:** A short beep each time you press a key on the keypad and it is acknowledged by the system.

**Prewarn tone:** A pulsed tone that sounds when you open an entry delay door on a system that is armed (turned on) reminding you to disarm the burglary protection. The tone silences as soon as the first user code digit key is pressed. If a valid user code is not entered or an invalid user code is entered within five seconds, the prewarn tone begins sounding again.

**Exit tone:** A pulsing tone that sounds during the exit countdown just after arming all areas of your system to remind you to exit the premise. At ten seconds prior to the end of the countdown, the rate of pulsing increases.

**Monitor tone:** A pulsed tone for one second, one pulse only that sounds whenever a door or window is opened while you are using the zone monitor function from the User Menu. See Zone Monitor.

**Note:** When toggling to a RMV monitor state, the Zone Monitor tone does not sound.

**Trouble tone:** A steady tone indicating a trouble condition on your system. Press a Select key to silence.

### What to do when the trouble tone sounds

You can silence the trouble tone by pressing any key.  
This only silences the keypad and does not correct the condition that originally caused the trouble.

## DMP Wireless

Your system may have DMP wireless devices including key fob(s). There are three types of DMP wireless key fobs available:

- 4-Button Model 1145-4-B Key Fob
- 2-Button Model 1145-2-B Key Fob
- 1-Button Model 1145-1-B Key Fob

The drawing shows the button layout for all three models. Each button on the key fob is programmed to perform a specific action. The button names are listed below.

- TOP = the Key Fob Top button
- BTM = the Key Fob Bottom button
- LFT = the Key Fob Left button
- RGT = the Key Fob Right button

The button programming list for the key fob(s) connected to your system is located in the System Setup section of this guide. Refer to Appendix D for LED Status operation information. Specific function labels can be added to each button to indicate button operation.

*Introduction*

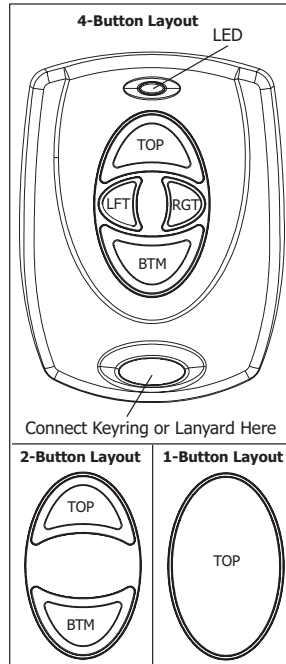

**Key Fob Examples and Button Names**

For best operation, allow the LED to light and turn off before pressing another button. The key fob may not complete sending the signal for the button press if another button is pressed too soon.

If there is no LED light, the battery for your key fob may need replacing, you could be out of range from the receiver, or the button is not programmed (programmed unused).

## Special Wireless Displays

Your system may use wireless transmitters to send alarm and trouble information from the protection devices to the panel. Wireless systems have a few unique keypad displays.

**BACK DOOR - LOBAT - (Low Battery)** The battery in a wireless transmitter is low. (BACK DOOR is used as an example only.)

**BACK DOOR - MISNG - (Missing)** The panel is not receiving the wireless transmitter periodic test report.

**WIRELESS - TRBL - (Trouble)** Some part of your wireless system is operating improperly. Call the service department for assistance.

**WIRELESS RECEIVER JAMMED - ALARM -** Your system may be programmed for wireless interference detection and, if displayed, your wireless receiver has detected a jamming signal while the system is armed.

**WIRELESS RECEIVER JAMMED - TRBL - (Trouble)** Your system may be programmed for wireless interference detection and, if displayed, your wireless receiver has detected a jamming signal while the system is disarmed.

## Special Keypad Displays

As you use your system, you occasionally see a keypad display that asks you to enter a code or that describes a condition on the system. Below are some examples of the keypad displays:

### ALARM

A 24-hour zone (for example fire or panic) or an armed burglary zone has been tripped. Your system may sound bells or sirens.

### TRBL (TROUBLE)

There is a problem with a protection device or system component. This display is accompanied by a description of the problem.

### ALARM NOT SENT

The alarm signal was aborted and was not sent to the central station because a valid user code was entered to disarm the system before the alarm signal was sent to the central station. Also, your system may be pre-programmed at installation to send an Abort signal to the Central Station that an alarm occurred but was not sent because the user entered a code before the delay time expired.

### ALARM CANCELLED

An Alarm signal just sent to the central station was cancelled because a valid user code was entered to disarm the system after the alarm was sent. Also, an Alarm Cancel signal is sent to the Central Station.

### ALARM VERIFIED

A valid burglar alarm has occurred and has been manually verified by the user. The alarm system also transmits a VERIFY message to the Central Station.

## ENTER CODE OR PRESENT CARD

The system requires you to enter your user code or present your user card/proximity credential to a keypad or card reader. User codes or reads can be required for turning your system on (arming), turning your system off (disarming), and many other functions.

As you enter your user code, the keypad display shows an asterisk (\*) in place of each digit pressed. This keeps others from seeing your user code on the display as it is entered.

## TRY AGAIN OR INVALID CODE/CARD/PIN

The user code, card read, or PIN you have used is not recognized by the system or is not authorized in their profile for that function. Check the User Code or PIN, or present the card to the reader again.

## INVALID PROFILE

All user codes have a profile that allow the user to only access certain functions. When users attempt functions outside their authority, the INVALID PROFILE message displays.

## INVALID AREA

A user has attempted a door access for an area they are not assigned.

## INVALID TIME

A user code assigned to a specific schedule is entered outside of the valid schedule. See Schedules and User Codes.

## ARMED AREA

A user has attempted a door access to an armed area to which they do not have arming and disarming authority.

## FAILED TO EXIT (ANTI-PASSBACK)

Anti-passback requires users to properly exit (egress) an area they have previously accessed. If they fail to exit through the proper

card reader location, they are not granted access on their next attempt. A Failed to Exit message appears when a user assigned the anti-passback option attempts to re-enter an area which they did not exit properly. The user must exit the area through the proper door. If not possible, your system administrator should select the Forgive option in the User Codes menu option.

### **SYSTEM TROUBLE or SERVICE REQUIRED**

There is a problem with one or more of the components in your system. Contact our service department as soon as possible.

### **SYSTEM BUSY**

The system is performing another task of a higher priority. This usually only takes a few moments.

### **TEST IN PROGRESS**

The system is currently being tested by an installation or service technician.

### **Cell Phone Messages**

Your system may be programmed at installation to send a variety of messages to your personal cell phone.

The message option uses your security system's reporting capability to send reports using a cell phone number in much the same way as someone sending an email would do. You can receive reports of alarms, troubles, or system arming and disarming and know at a glance your system status. See Appendix F for more information.

### **MyAccess™ Text Messaging Commands**

Your system may be programmed to allow simple text messages to be sent to the security system to perform basic user operations. By texting a message from your cell phone or PDA, the following actions can be performed: Arm/Disarm, check Armed Status, Cancel Alarm, and turn Outputs On/Off. See Appendix F for more information.

## **Understanding Security System Terms**

Throughout this guide, and in some displays on your keypad, you may see certain words or phrases that might be unfamiliar. Below are some terms you may see here and on your keypad display:

### **Access (Door Access)**

Entry/Exit doors that are used to restrict access to the building or provide door access to authorized users. When a user code is entered at the keypad by entering a code or presenting a card to a reader, the system verifies authority and unlocks the door for a short period of time. See Easy Entry User's Guide in Appendix E.

### **Areas**

An area is made up of burglary zones that can be armed or disarmed together. One area might consist of the office doors and windows. When you arm the office, these zones arm together and sound an alarm if opened.

### **Arming**

Turns on the burglary protection in one or more areas of the system. When armed, the system is able to sound alarm bells or sirens and, if monitored, send alarm reports to a central station when a burglary zone is tripped.

Fire, panic, and other 24-hour devices are always turned on and do not need to be armed.

### **Central Station Monitoring**

Your system can also be programmed to automatically send alarm, trouble, and arming and disarming reports to a central station. Operators at the central station dispatch the appropriate authorities or contact you with the specific event information.

## **Disarming**

Turns off one or more areas of the system. When disarmed, the system does NOT sound alarms or send alarm reports to a central station when a burglary zone faults.

## **Fault**

You may see the keypad display FRONT DOOR –FAULT. This means that there is a problem with the front door, such as the door being open when you are arming the system. If you see a –FAULT display, attempt to correct the problem (in this case shut the door). After the zone is in a normal state, you may arm the system. You may also bypass the zone and then arm the system.

## **Zone**

A zone refers to one or more protected openings (doors or windows) or protection devices (motion or glassbreak detectors) grouped together under the same zone name and number.

Often, similar devices in the same general location share the same zone. For example, the windows on the east side of the premises can all be grouped together in a zone named E. WINDOWS.

## **Instant Zone**

Interior protection devices and perimeter devices, such as exterior windows, passive infrared detectors (PIR), and non entry doors, are typically not programmed with delay times. If these zones are tripped while the system is armed, an alarm instantly occurs.

## **24-hour Zone**

A 24-hour zone is not turned on or off by arming or disarming your system. Some examples of 24-hour zones are fire zones, panic zones, and temperature control zones.

## **Entry or Exit zone**

Almost all systems have one or more doors through which you can access the premises. These doors are programmed with a delay

time to allow you to enter or exit without setting off the alarm.

When you arm the system, activity on this zone is ignored until the exit delay time expires. Once that time has expired and the system is fully armed, opening the door causes the panel to start the entry delay time. During the entry delay time, you must enter a valid user code to disarm the system or an alarm occurs.

## **Status**

Status is a feature that automatically displays the armed or disarmed status of your system on the keypads. Alarm or trouble conditions on a zone or a system monitor such as AC or battery trouble can also display. There are two types of status information available: Armed Status and Status List.

### **Status List**

The keypad Status List displays any alarm or trouble condition on a zone, and any trouble condition on an internal system monitor. The system monitors include the AC power, battery power, panel box tamper, printer, and phone lines. If more than one alarm or trouble condition occurs at the same time, the keypad sequences this information on its display.

If the alarm is from a 24-hour zone or a system monitor, it remains in the Status List until it restores. If one or more armed burglary zones trip at the same time, the last one to trip remains in the Status List. This is to ensure that if a burglary has occurred the last zone tripped remains displayed even if it has been restored.

### **Armed Status**

Armed Status is the keypad display of the current armed condition of areas within your security system.

If your system is set up as an Area system with areas one to eight, the display shows: 1 2 3 4 5 6 7 8. When you arm areas 1, 3, 5, and 7 the keypad displays: 1 3 5 7.



If your Area system is setup with nine or higher areas and the system is armed, the display reads: ALL SYSTEM ON or SYSTEM ON. Refer to Checking Armed Areas for information about checking the armed areas.

If your system is set up as a Home/Sleep/Away or All/Perimeter system, one of the following displays indicate the current Armed Status:

| The keypad displays    | When   |
|------------------------|--|
| <b>HOME SYSTEM ON</b>  | The perimeter is armed in a Home/Sleep/Away system.                    |
| <b>PERIMETER ON</b>    | The perimeter is armed in an All/Perimeter system.                     |
| <b>ALL SYSTEM ON</b>   | All areas are armed.   |
| <b>SLEEP SYSTEM ON</b> | The perimeter and interior are armed but the bedroom area is disarmed. |

If your system is set up as a Home/Sleep/Away with Guest system, the arming status of the main system is the same as a standard Home/Sleep/Away system. The current arming status of the Guest systems displays as follows:

| The keypad displays     | When   |
|-------------------------|--|
| <b>HOME GUEST 1 ON</b>  | The first guest house perimeter is armed in a Home/Sleep/Away with Guest system.         |
| <b>SLEEP GUEST 1 ON</b> | The first guest house perimeter and interior are armed but the bedroom area is disarmed. |
| <b>ALL GUEST 1 ON</b>   | All first guest house areas are armed.   |

**Note:** The XR150 system allows one guest house system while the XR350 and XR550 allows two guest house systems.

Also, for keypads that include an Armed LED, the Armed LED is ON steady when ALL areas assigned to that keypad are armed and OFF when any area assigned to that keypad is disarmed.

#### View Zone Status

To view disarmed zones that are in fault, press any Select key when the status list displays.

#### Browser Feature

Refer to Appendix B at the back of this guide for diagrams showing you how to use the built-in browsers.

# Arming and Disarming

## General Arming Operation

Your system has been programmed to operate in one of four configurations: Area, All/Perimeter, Home/Sleep/Away, or Home/Sleep/Away with Guest.

- **Area** – Your burglary protection is divided into up to 32 areas. Each area can have a custom name, be turned on or off independently of other areas, and limit access to only those users with proper authority.
- **All/Perimeter** – Your burglary protection is divided into two areas: Interior and Perimeter.  
Perimeter arming is when you are staying inside but want the comfort of knowing the exterior doors and windows are armed. Perimeter arming allows you to move freely about inside without setting off any interior alarms.  
All arms both the Perimeter and the Interior of the system. You want to arm both of these areas when leaving the building and no one is left inside.
- **Home/Sleep/Away** – Your burglary protection is divided into two or three areas: Perimeter, Interior, and Bedrooms.  
Home (Perimeter) arming is when you are staying inside but want the comfort of knowing the exterior doors and windows are armed.  
Sleep (Optional) (Perimeter and Interior) arms all areas except those near bedrooms and nighttime areas.  
Away (Perimeter, Interior, and Bedrooms) arms all three areas when you leave the building and no one is left inside.
- **Home/Sleep/Away with Guest** – Your burglary protection has a main house system and up to two guest house systems (XR150 has 1 guest house system while XR350 and XR550 offers 2). Each house is separate and works just like the Home/Sleep/Away system previously mentioned.

Regardless of which configuration is programmed, much of the operation is similar. Throughout this guide, any differences between the systems are noted for your convenience.

## Arming Functions

**Arming or Disarming:** You can arm and disarm all areas at one time or each area individually. You can only arm or disarm areas authorized for your user code.

**Arm All or Selective Arming:** After entering your user code, the system allows you to arm either all of the areas to which you have access or one or more selected areas. If you choose to arm all areas, the system begins verifying that all zones in those areas are in a good condition. If you choose to arm selected areas, the system prompts you to choose the areas you want to arm.

After making your arming selection, the keypad displays any zones that are currently bypassed. These zones remain bypassed until the system is armed and then disarmed. Any 24-hour zones in a faulted condition also display.

**Bypassing Zones:** Before arming, the system verifies that all doors, windows, and other protection devices to be armed are in normal condition. If everything is verified, the system arms. If there is a problem on one or more burglary zones, the system cannot arm until the problem is corrected. If the problem is simply an open door or window, correct the problem and try arming again.

If the problem cannot be corrected, you can force arm or bypass the zone or wait until the zone can be repaired by a service technician. A force armed zone is ignored by the system until it restores to normal. A bypassed zone is ignored by the system during the entire armed period. A zone remains bypassed until the system is disarmed.

In some cases, you might see the keypad display FRONT DOOR – FAULT. The keypad then displays priority zone which is a zone that cannot be bypassed. The problem on the zone must be corrected before the system can be armed.

When choosing to bypass a protection device or zone, there may be a pre-programmed maximum number of zones (up to 8) that can be bypassed in an area when that area is being armed. This limit is programmed at installation.

#### **Arming Messages:**

For **Area** systems the keypad briefly displays SYSTEM ON if only selected areas are armed. The keypad briefly displays ALL SYSTEM ON when all areas in the system are armed.

For **All/Perimeter** systems the keypad briefly displays PERIMETER ON if only selected areas are arming. The keypad briefly displays ALL SYSTEM ON when all areas in the system are armed.

For **Home/Sleep/Away** systems the keypad displays HOME SYSTEM ON or SLEEP SYSTEM ON if only selected areas are arming. The keypad briefly displays ALL SYSTEM ON when all areas in the system are armed.

For **Home/Sleep/Away with Guest** systems the main system arms the same as a Home/Sleep/Away system. A keypad assigned to the first guest house system displays HOME GUEST 1 ON or SLEEP GUEST 1 ON if only selected areas are arming. The keypad displays ALL GUEST 1 ON when all areas in the guest house system are armed.

**Exit Delay:** The keypad then displays the exit delay time as it counts down. Your system may be pre-programmed at installation to beep the exit delay tone at eight-second intervals until the last 10 seconds when the keypad beeps at three-second intervals. After exiting the building, if you re-enter during the countdown the exit countdown restarts, allowing additional time to then disarm or again exit the building during the countdown. This restart can occur only one time. When the exit delay time expires, all disarmed zones are armed.

**Note:** If your system uses a keyswitch to arm an area, the exit delay time does NOT show on the keypad display.

When you arm both the Perimeter and Interior to leave the building but then you do not exit by the time the exit delay ends, the system automatically arms but the interior area(s) will remain disarmed because you have not exited.

Should you exit the building and the door does not close properly, your system may be programmed so that when the exit delay countdown ends, then the entry delay starts and the bell will sound to alert you to the situation. Enter your user code to stop the bell and disarm the system. Rearm the system, exit the building, and make sure the door is securely closed.

**ONE MOMENT . . . Message:** If your system is monitored, it may be programmed to wait for the arming report transmission to the central station before displaying the armed message. This verifies your phone lines are working properly. While the system is waiting for the transmission, the display reads ONE MOMENT... If the report is received, the keypad displays the armed message. If the report is not received, the keypad displays LOCAL ALARM ONLY before displaying the armed message.

**Note:** Your system may be pre-programmed at installation to:

- send arming or zone bypassing reports to a central station
- arm and/or disarm specific areas at specific keypads.

#### **Key Fob Arming**

Press and hold the key fob button programmed for Arming or the Toggle arm/disarm button. The Red LED two-second acknowledgement light indicates All System On. The Green/Red two-second acknowledgement light indicates System On with some areas armed.

## Key Fob Disarming

Press and hold the key fob button programmed for Disarming or the Toggle arm/disarm button. The Green LED two-second acknowledgement light indicates All System Off.

## Area System Arming Operation

**Area Assignment:** Your security system has been set up into separate areas. The number of areas and their names are listed on the table in System Setup.

### Arming the Area System

1. Press the COMMAND key until ARM DISARM is displayed.
2. Select ARM to arm the system.
3. Enter your user code if required. The keypad displays ALL? NO YES.
4. Select NO to arm only selected areas. Go to step 5. Select YES to arm all areas authorized for your user code. Go to step 6.
5. If you selected NO in step 4, the display begins to list each area to which you have access followed by NO YES.  
Example: OFFICE NO YES
- 5a. Select YES for each area you want to arm.
- 5b. Select NO for each area you do not want to arm.
6. The system displays any bypassed zones or faulted 24-hour or Priority zones. A faulted Priority zone cannot be armed.
7. At this point you can force arm or bypass any faulted zones. A zone that is force armed is restored into the system if it later returns to normal. A zone that is bypassed remains bypassed until the system is disarmed. See steps 7a through 7d.
- 7a. If a problem exists on a zone, the zone name and problem is shown followed by: OKAY BYPASS STOP.
- 7b. Select OKAY to force arm the faulted zone.

- 7c. Select BYPASS to bypass all faulted zones being displayed.

**Note:** 24-hour zones cannot be bypassed.

- 7d. Select STOP to stop the system from arming. Correct the zone problem(s) and return to step 1.

Your system may be programmed to require a user code that has authorization to force arm or bypass a faulted zone. To force arm or bypass a faulted zone, the system asks you to enter a user code.

8. The display reads SYSTEM ON if at least one area in the system is armed, and ALL SYSTEM ON if all areas in the system are armed.

**Note:** Your system may be pre-programmed at installation for the Instant Arming option.

9. The keypad next displays EXIT: ## INSTANT and begins to count down the number of seconds remaining for you to exit. When the delay expires, the exit zones are armed.
10. You can select INSTANT while EXIT: ## INSTANT is displayed to immediately arm all exit zones and make them instant. The keypad displays INSTANT.

### Quick Arming

To quickly arm a desired area, enter the area number followed by the COMMAND key when the ALL? NO YES option displays.

### Checking the Armed Areas

After you have armed the system, you may press any Select key to check the armed areas when ALL SYSTEM ON or SYSTEM ON displays. The keypad then displays CHK ARMED AREAS: NAME NBR LIST.

Select NAME to list all of the armed areas by name. Select NBR to enter the area number you would like to check. Select LIST to list all of the armed areas by number.

## Area System Disarming Operation

While the system is armed, you can only enter the premises through an entry/exit delay door without causing an alarm. After opening the door, the keypad sounds a prewarn tone to remind you to disarm the system. You must disarm the system before the entry delay time expires or an alarm on the door zone occurs.

During the entry delay time, the keypad displays ENTER CODE: and the name of the zone causing the entry delay. Enter your code to disarm the system. Only those areas assigned to your code disarms.

**Note:** The prewarn tone silences as soon as the first user code digit key is pressed. If a valid user code is not entered or an invalid user code is entered within five seconds, the prewarn tone begins sounding again.

**Schedules:** If you have programmed schedules for your system and a code is entered outside of a schedule and that code does not have authorization to disarm outside of schedules, the keypad displays INVALID TIME. This lets users know that they are attempting to disarm outside of their authorized time.

**All or Selective Disarming:** After entering your user code, the system allows you to disarm either all of the areas to which you have access or just selected areas. If you choose to disarm all areas, the system automatically disarms them. If you choose to disarm selected areas, the area names display on the keypad.

**Alarm Display:** After disarming, the keypad displays any zones that tripped or any transmission problems that occurred during the armed period. All burglary zones are then disarmed and any by-passed zones are automatically reset.

**Disarmed Message:** The keypad displays ALL SYSTEM OFF after the system disarms.

**Central Station Report:** Your system may be pre-programmed at installation to transmit a system disarming report to the central station.

**Door Access Disarming:** Your system may be programmed to allow area disarming when a card is presented to a door access reader located outside of the building. Simply present your card to the reader and after the card code is validated for the appropriate authority, a door access is granted and your matching areas are automatically disarmed. See the Easy Entry™ User's Guide in Appendix E.

## Disarming the Area System from the keypad

1. Press the COMMAND key until ARM DISARM displays. During entry delay this process starts at step 3.
2. Select DISARM to disarm areas.
3. The keypad displays ENTER CODE: .Enter your user code and press COMMAND. The keypad displays ALL? NO YES.
4. Select YES to disarm all areas authorized for your user code. Select NO to disarm only certain areas individually. The keypad then displays the name of each area authorized for your user code followed by the NO YES display. Select YES to disarm the area displayed. Select NO to not disarm the area and display the next area.
5. If you are disarming the system out of a normally scheduled time and you have the authority to extend a schedule, the keypad then displays 2HR 4HR 6HR 8HR. Select the number of hours to extend the schedule.

**Note:** If you do not have the authority to extend a schedule, this option does not display.

6. After all areas have displayed and schedules extended, any alarms or communication problems that occurred during the armed period display.
7. If all areas have been disarmed, the keypad next displays ALL SYSTEM OFF.

## Quick Disarming

To quickly disarm a desired area, enter the area number followed by the COMMAND key when the ALL? NO YES option displays.

## All/Perimeter System Arming

**Area Assignment:** Your security system is divided into two separate areas. Motion detectors, inside doors, and other interior protection devices are assigned to the Interior area while windows and exterior doors are assigned to the Perimeter area.

**Perimeter or All:** When arming an All/Perimeter system, the keypad displays PERIM ALL. If you select ALL, you are arming both the Perimeter and the Interior areas of the system. You will want to arm both of these areas when leaving the premises with nobody left inside. Selecting PERIM arms only the perimeter of the system. Perimeter arming is when you're staying inside but want the comfort of knowing the exterior doors and windows are armed. Perimeter arming allows you to move freely about inside without setting off any interior alarms.

**Instant:** During the exit delay time, you can cancel the exit and entry delays and cause all zones to be instant zones. Just press the far right Select key under INSTNT while the exit delay is displayed. This immediately arms the exit zones. However, no entry delay is provided and an alarm will occur should an entry door be opened.

## System Ready/System Not Ready

When all zones in the system are in a normal condition and can be armed without bypassing, the keypad displays SYSTEM READY. If there are one or more zones that are not in a normal condition, the keypad displays SYSTEM NOT READY. Pressing any Select key during this display shows the zone number and name allowing you to investigate the problem.

## All/Perimeter Shortcut Key Arming

**Arm Perimeter** – Press 6 for 2 seconds.

**Arm All** – Press 1 for 2 seconds.

## Arming an All/Perimeter System

1. Enter your 4-digit user code. The keypad displays PERIM ALL.
2. Select PERIM to arm the Perimeter area only.
3. Select ALL to arm both the Perimeter and Interior areas.
4. The keypad displays zones that have been bypassed prior to arming and zones that are now in a faulted condition.
5. At this point you can force arm or bypass any faulted zones. A zone that is force armed is restored into the system if it later returns to normal. A bypassed zone remains bypassed until the system is disarmed. See steps 5a through 5d.
  - 5a. If a problem exists on any zones, the zone name and problem display followed by: OKAY BYPASS STOP.
  - 5b. Select OKAY to force arm the zone(s) before arming.
  - 5c. Select BYPASS to bypass the zone(s) before arming.
  - 5d. Select STOP to stop the system from arming. Correct the zone problem(s) and return to step 1.
6. The keypad displays PERIMETER ON if only the perimeter is being armed and ALL SYSTEM ON if both the perimeter and interior are being armed.

7. If arming Perimeter, the keypad displays EXIT: ## INSTNT and begins to count down the number of seconds remaining for you to exit. When the delay expires, all zones are armed.
8. You can select INSTNT while EXIT: ## INSTNT displays to immediately arm all zones and make them instant. The keypad displays INSTANT. When you select INSTANT, any entry/exit zone that trips immediately activates an alarm and the exit delay countdown immediately stops.
9. When the system is fully armed, the keypad displays PERIMETER ON for perimeter arming and ALL SYSTEM ON for perimeter and interior arming.

## All/Perimeter System Disarming

**Disarming:** While the system is armed, you can only enter the premises through an entry/exit delay door without causing an alarm. After opening the door, the keypad sounds a prewarn tone to remind you to disarm the system. You must disarm the system before the prewarn tone expires or an alarm on the door zone will occur.

During the prewarn tone, the keypad displays ENTER CODE:. Enter your user code to disarm the system.

**Schedules:** If you have programmed schedules for your system and a user code is entered outside of a schedule, the keypad displays INVALID TIME. This lets the user know that they are disarming outside of their authorized time.

**Alarm Display:** After disarming, the keypad displays any zones that tripped or any transmission problems that occurred during the armed period. All burglary zones are then disarmed and any by-passed zones are automatically reset.

**Disarmed Message:** The keypad displays ALL SYSTEM OFF after the system disarms.

**Central Station Report:** A report of the system disarming can be transmitted to the central station. This is optional and can be programmed for you at any time.

## Disarming an All/Perimeter System

1. During the entry delay time, the keypad displays ENTER CODE:. Enter your 4-digit user code.
2. The keypad then displays any zones that went into alarm or any communication problems that occurred during the armed period.
3. The keypad next displays ALL SYSTEM OFF to confirm the system is disarmed.

## Disarming During an Alarm

1. While the alarm bell or siren sounds, enter your user code to silence the alarm. The keypad tone silences as soon as the first key is pressed.

For a burglary alarm, the keypad displays IS THIS A FALSE ALARM? CANCEL VERIFY.

This allows you to investigate the alarm prior to disarming the system. This display remains on the keypad until a selection is made, the Back Arrow is pressed, or the internal system bell cutoff timer expires.

2. If a valid alarm has not occurred, select YES or CANCEL to disarm the system and cancel the alarm.

The keypad next displays ALL SYSTEM OFF to confirm the system is disarmed.

OR

If the alarm is valid, select NO or VERIFY and send a verify message to the Central Station.

## Home/Sleep/Away and Home/Sleep/Away with Guest System Arming

**Area Assignment:** Your security system is divided into two or three separate areas. Motion detectors, inside doors, and other interior devices are assigned to an Interior and Bedroom areas while windows and exterior doors are assigned to a Perimeter area.

**Arming the system:** When arming a Home/Sleep/Away or a Home/Sleep/Away with Guest system, the keypad displays HOME AWAY or HOME SLEEP AWAY. If you select AWAY, you arm all areas of the system. You will want to arm all areas when leaving with nobody staying inside. Selecting HOME arms only the Perimeter of the system. Perimeter arming is when you are staying inside but want the comfort of knowing the exterior doors and windows are armed. Perimeter arming allows you to move freely about inside without setting off any interior alarms. Selecting SLEEP arms the Perimeter and Interior devices but leaves devices near bedrooms or other nighttime areas off.

## System Ready/System Not Ready Keypad Displays

When all zones in the system are in a normal condition and can be armed without bypassing, the keypad displays SYSTEM READY. If there are one or more zones that are not in a normal condition, the keypad displays SYSTEM NOT READY. Pressing any top row Select key during this display shows the zone number and name allowing you to investigate the problem.

## Home/Sleep/Away and Home/Sleep/Away with Guest Shortcut Key Arming

**Arm Home** — Press 3 for 2 seconds to arm the perimeter.

**Arm Sleep** — Press 7 for 2 seconds to arm the perimeter and interior areas and leave the bedroom area off.

**Arm Away** — Press 1 for 2 seconds.

## Arming a Home/Sleep/Away or a Home/Sleep/Away with Guest System

1. Enter your 4-digit user code. The keypad displays HOME SLEEP AWAY.
2. Select HOME to arm the Perimeter only.
3. Select SLEEP to arm the Perimeter and Interior.
4. Select AWAY to arm the Perimeter, Interior, and Bedroom.
5. The system displays any Bypassed zones or faulted 24-hour or Priority zones. A faulted Priority zone cannot be armed.
6. At this point you can force arm or bypass any faulted zones. A zone that is force armed will be restored into the system if it later returns to normal. A zone that is bypassed will remain bypassed until the system is disarmed. See 6a through 6d.
  - 6a. If a problem exists on a zone, the zone name and problem is shown followed by OKAY BYPASS STOP.
  - 6b. Select OKAY to force arm the zone(s) before arming.
  - 6c. Select BYPASS to bypass the zone(s) before arming.
  - 6d. Select STOP to stop the system from arming. Correct the zone problem(s) and return to step 1.
7. A Home/Sleep/Away system keypad displays HOME SYSTEM ON if you selected HOME, SLEEP SYSTEM ON if you selected SLEEP, and ALL SYSTEM ON if you selected AWAY. A Home/Sleep/Away with Guest system keypad displays HOME GUEST 1 (or 2) ON if you selected HOME, SLEEP GUEST 1 (or 2) ON if you selected SLEEP, and ALL GUEST 1 (or 2) ON



if you selected AWAY.

8. If arming the Perimeter, the keypad next displays EXIT: ## INSTNT and begins to count down the number of seconds remaining for you to exit. When the delay expires, the exit zones are armed.
9. You can select INSTNT while EXIT: ## INSTNT is displayed to immediately arm all exit zones and make them instant. The keypad displays INSTANT.

## Home/Sleep/Away and Home/Sleep/Away with Guest System Disarming

**Disarming:** While the system is armed, you can only enter the premises through an entry/exit delay door without causing an alarm. After opening the door, the keypad sounds a prewarn tone to remind you to disarm the system. You must disarm the system before the prewarn tone expires or an alarm on the door zone will occur.

During the prewarn tone, the keypad displays ENTER CODE:. Enter your user code to disarm the system.

**Schedules:** If you have programmed schedules for your system and a user code is entered outside of a schedule, the keypad displays INVALID TIME. This lets the user know that they are disarming outside of their authorized time.

**Alarm Display:** After disarming, the keypad displays any zones that tripped or any transmission problems that occurred during the armed period. All burglary zones are then disarmed and any by-passed zones are automatically reset.

**Disarmed Message:** The keypad displays ALL SYSTEM OFF after the system disarms.

**Central Station Report:** A report of the system disarming can be transmitted to the central station. This is optional and can be programmed for you at any time.

## Disarming a Home/Sleep/Away or a Home/Sleep/Away with Guest System

1. During the entry delay time, the keypad displays ENTER CODE:. Enter your 4-digit user code.
2. The keypad then displays any alarms or communication problems that occurred during the armed period.
3. The keypad next displays ALL SYSTEM OFF to confirm the system is disarmed.

## Disarming During an Alarm

1. While the alarm bell or siren sounds, enter your user code to silence the alarm. The keypad tone silences as soon as the first key is pressed.

For a burglary alarm, the keypad displays IS THIS A FALSE ALARM? CANCEL VERIFY.

This allows you to investigate the alarm prior to disarming the system. This display remains on the keypad until a selection is made, the Back Arrow is pressed, or the internal system bell cutoff timer expires.

2. If a valid alarm has not occurred, select YES or CANCEL to disarm the system and cancel the alarm.

The keypad next displays ALL SYSTEM OFF to confirm the system is disarmed.

OR

If the alarm is valid, select NO or VERIFY and send a verify message to the Central Station.

## Extending Schedules

Depending on your system programming, when the open schedule ends, you can extend the schedule to a later time. The keypad buzzer sounds and the keypad displays "area name" and LATE or CLOSING TIME!. This reminds users still on the premises to arm the system or extend the schedule.

To extend the system schedule:

1. Press any Select key. The keypad displays ENTER CODE: - .
2. Enter your code and press COMMAND or present your access card to a valid reader.
3. The keypad then displays 2HR 4HR 6HR 8HR. Select the number of hours to extend the schedule.

**Note:** If the system is not armed by the scheduled closing time, a Late to Close report is sent to the central station. If the schedule is extended, a Schedule Change report may be sent to the central station.

For information about extending a schedule before the scheduled closing time is reached, see Extending Schedules (EXT) in the User Menu portion of this guide.

## Keypad Shortcut Keys

Your two-line display keypads provide one-button shortcut keys. Holding down a keypad button for two seconds until the tone sounds allows you to arm, monitor, or reset your system. These options can still be accessed through the User Menu if desired.

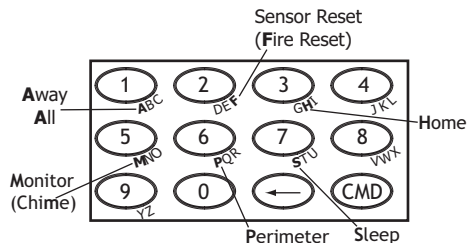

### Keypad Shortcut Keys

#### Keypad Key

Press Key 1

Press Key 2

Press Key 3

Press Key 5

Press Key 6

Press Key 7

#### Arming System Operation

Arm Away for Home/Sleep/Away systems

Arm Away for Home/Sleep/Away with Guest systems

Arm All for All/Perimeter systems

Sensor (Fire) Reset on all systems

Arm Home for Home/Sleep/Away systems

Arm Home for Home/Sleep/Away with Guest systems

Monitor (Chime) on all systems

Arm Perimeter for All/Perimeter systems

Arm Sleep for Home/Sleep/Away systems

Arm Sleep for Home/Sleep/Away with Guest system

## Arming Function

**System Operation:** Home/Sleep/Away, Home/Sleep/Away with Guest, or All/Perimeter.

You can use the Arming shortcut keys, 1, 3, 6, and 7 when the system is disarmed. You may be prompted to enter your user code.

If any zones are faulted, select force arm or bypass. Refer to the Arming Section for detailed arming operation.

### Home/Sleep/Away and Home/Sleep/Away with Guest Arming

**Arm Home** – Press 3 for 2 seconds to arm the perimeter.

**Arm Sleep** – Press 7 for 2 seconds to arm the perimeter and interior areas and leave the bedroom area off.

**Arm Away** – Press 1 for 2 seconds.

### All/Perimeter Arming

**Arm Perimeter** – Press 6 for 2 seconds.

**Arm All**– Press 1 for 2 seconds.

## Sensor (Fire) Reset Function

**System Operation:** Area, Home/Sleep/Away, Home/Sleep/Away with Guest, or All/Perimeter.

You can use the Sensor (Fire) Reset, shortcut key 2, when the system is armed or disarmed. When pressed, detectors that have latched due to an alarm condition are returned to normal function. The keypad displays SENSORS ON and SENSORS OFF to acknowledge the shortcut key press.

**Note:** You may be prompted to enter your User Code.

## Monitor (Chime) Function

**System Operation:** Area, Home/Sleep/Away, Home/Sleep/Away with Guest, or All/Perimeter.

You can use the Monitor (Chime), shortcut key 5, when the system is disarmed. When pressed, the Zone Monitor operation is initiated. As needed, refer to the Zone Monitor section. The keypad displays MONITOR ON and chimes or displays MONITOR OFF and no tone is sounded.

**Note:** The Monitor (Chime) shortcut key applies to all Exit zones in an Area system and to all zones assigned to the perimeter in a Home/Sleep/Away, Home/Sleep/Away with Guest, or All/Perimeter system.

*Arming and Disarming*

# User Menu

Many system features are programmed into a User Menu that you can access from any keypad. The menu requires you to enter your user code and then it only shows those functions to which you have access.

## Accessing the User Menu

1. Press the COMMAND key, if the multi-language option is enabled, the available languages display. Select the language to use for text display.
2. Press the COMMAND key until MENU? NO YES displays.
3. Select YES. The keypad displays ENTER CODE: -. Enter your user code and press COMMAND. You can now scroll down through the list of system features available to you.

## User Menu Options

The list below shows the User Menu options in order:

| Menu Option      | Description  |
|------------------|--|
| ALARM SILENCE    | Silences an alarm bell or siren.   |
| SENSOR RESET     | Resets smoke or glassbreak detectors that have latched due to an alarm condition.                    |
| LOCKDOWN         | Immediately locks all Public Doors.  |
| DOOR LOCK/UNLOCK | Immediately locks or unlocks a selected door.  |
| DOOR ACCESS      | Momentarily opens the keypad door lock relay.  |
| ARMED AREAS      | Displays the name of any areas in the system that are currently in the armed state.                  |
| OUTPUTS ON/OFF   | Allows you to turn on or off any of the outputs described in the System Setup section of this guide. |
| FAVORITES        | Allows you to activate any Favorite described in the System Setup section of this guide.             |

|                       |  |                        |  |
|-----------------------|--|------------------------|--|
| <b>Z-WAVE SETUP</b>   | Allows you to Add, List, Remove, Transfer, and Rediscover Z-Wave devices in your system. You can create Z-Wave Favorites, Add, Edit, and Remove Z-Wave devices in Favorites.                             | <b>SERVICE REQUEST</b> | occurred on your system. Allows you to send a message to the Central Station requesting service on the alarm system. |
| <b>ZONE STATUS</b>    | Allows you to see if a zone is either armed, bypassed, in alarm, open, or shorted.   | <b>FIRE DRILL</b>      | Allows you to test the system fire bells.  |
| <b>BYPASS ZONES</b>   | Allows you to Bypass a zone or reset an already bypassed zone.   |                        |  |
| <b>ZONE MONITOR</b>   | Allows you to add or remove a zone from the monitor mode.  |                        |  |
| <b>SYSTEM STATUS</b>  | Displays the current condition of the system AC power, backup battery, and optional panel tamper.  |                        |  |
| <b>SYSTEM TEST</b>    | Tests the system siren, communication to the central station, and backup battery on all XR150, XR350, and XR550 Series panels. XR550N or XR550E panels allow additional panic zone testing.              |                        |  |
| <b>USER PROFILES</b>  | Allows you to add, delete, or change user profiles.  |                        |  |
| <b>USER CODES</b>     | Allows you to add, delete, or change user codes.   |                        |  |
| <b>EXTEND CLOSING</b> | Allows the Closing Check operation to delay until the new closing time expires. This allows the current schedule to ignore its closing time and not send a LATE TO CLOSE message to the central station. |                        |  |
| <b>SCHEDULES</b>      | Allows you to add, remove, or change system schedules.   |                        |  |
| <b>TIME</b>           | Allows you to change the Day, Date, or Time that is currently programmed in the system.  |                        |  |
| <b>DISPLAY EVENTS</b> | Allows you to view or print the last 10,000 door accesses or 2,000 system events that  |                        |  |

## Alarm Silence

Silences the alarm bells or sirens during an alarm.

Alarm Silence allows you to turn off the alarm bells and sirens connected to your system during an alarm. Using Alarm Silence does NOT stop an alarm report from being sent to the central station and does not reset any alarmed devices. Use the Sensor Reset function to reset devices such as smoke detectors that have latched in alarm.

**Note:** The keypad tone silences as soon as the first user code digit key is pressed. You can silence the alarm by entering your user code or by presenting your card to a reader during the Status List display. If using a card, areas assigned to your code are disarmed and door access occurs.

### Using the Alarm Silence Function

1. Access the User Menu.
2. The keypad displays ALARM SILENCE?.
3. Press any Select key to silence the bells and exit the User Menu.

## Sensor Reset

Resets smoke or glassbreak detectors. Also clears Fire/Supervisory alarm, trouble displays or low battery displays on systems using wireless sensors.

Sensor Reset is used to reset smoke and glassbreak detectors after they have tripped. Once these detectors trip, they must be reset before they can detect any additional alarm conditions. When you select Sensor Reset, power to the detectors is temporarily removed by the system allowing them to reset.

Make sure all smoke is cleared from around the area of the smoke detectors before performing a Sensor Reset to prevent the alarm from occurring again.

### Sensor (Fire) Reset Shortcut Key

**All Systems** – Press 2 for 2 seconds, then enter your user code if required, to reset the system.

### Resetting the Sensors

1. Access the User Menu.
2. Press COMMAND until SENSOR RESET? displays.
3. The keypad displays SENSORS OFF followed by SENSORS ON.
4. The keypad automatically exits the User Menu.

## Lockdown

Your system may be programmed at installation for an access control door to be a Public Door. Enabling Lockdown locks all Public Doors from the keypad in an emergency situation.

### Using Lockdown

1. Access the User Menu.
2. Press COMMAND until LOCKDOWN? displays.
3. Press any Select key. The door access relay is activated and all Public Doors are locked.
4. Press COMMAND to return to the Status List display.

## Door Lock/Unlock

Locks and unlocks doors from the keypad.

### Using Door Lock/Unlock

1. Access the User Menu.
2. Press COMMAND until DOOR LOCK/UNLOCK? displays.
3. Enter the door number and press COMMAND.

-OR-

Press the fourth Select Key to browse door names. Use the COMMAND key to scroll through names and press any Select Key when the desired door is displayed.

4. Press the Back Arrow key to return to the DOOR LOCK/UNLOCK? display.

## Door Access

Operates an electric door strike from the keypad.

**Note:** The door strike function is not available on Clear Touch™ keypads or the Model 7872 Graphic Touchscreen keypad.

Door Access is used to operate the door strike relay that is built into some keypads. Power for the door strike is connected to the keypad relay and can be interrupted by using the Door Access function.

When Status List displays, you can operate Door Access by simply entering your user code and pressing COMMAND. See Easy Entry™ User's Guide in Appendix E. If you are using a keypad that has a built-in card reader, you may simply present your card to be allowed Door Access.

**Note:** Your system may be pre-programmed at installation to transmit a door access report to the central station.

## Using the Door Access

1. Access the User Menu.
2. Press COMMAND until DOOR ACCESS? displays.
3. Press any Select key. The door strike relay turns on momentarily.
4. The keypad returns to the Status List display.

## Armed Areas Display

Displays all armed area names in the system.

The Armed Areas display lists all of the names of the armed areas in your system at the keypads.

### Using the Armed Areas Function

1. Access the User Menu.
2. Press COMMAND until ARMED AREAS? displays.
3. Press any Select key. The keypad displays the first armed area name. To scroll through the list of armed area names, press the COMMAND key.
4. If there are no armed areas, the keypad displays NONE.

## Outputs On Off

This function is used to individually turn your system relay and door access outputs ON and OFF. Your system may use these outputs to control door access, interior and exterior lighting, heating, air conditioning, or other appliances.

The names and numbers of the relays connected to your system are located in the System Setup section of this guide.

Outputs can be turned ON or OFF regardless of the output settings in Schedules.

Your system may be programmed to require that your user code profile have access to areas assigned to the keypad. INVALID AREA displays when your user code does not have access to the keypad's areas and the output does not turn on.

Under certain conditions, some outputs cannot be turned on. If you select a restricted output, the keypad displays CANNOT TURN ON.

Note: Z-Wave Setup will not be available to the user if Outputs On Off is not enabled for the User in User Profiles.

### **Turning the Outputs ON and OFF**

1. Access the User Menu.
2. Press COMMAND until OUTPUTS ON/OFF? displays.
3. Press any Select key.
4. Enter the output number you want to turn ON or OFF. The output number displays.
5. With the output number displayed, select ON or OFF. The output then turns ON or OFF depending on your selection, and remains in that state until you change it. The keypad displays the first 12 characters of the output or door name followed by either ON or OFF for four seconds to provide visual verification of the action. Press the COMMAND key to end the four second display.
6. The system automatically returns to the output or door option and a new output can be selected to turn ON or OFF. Refer back to step 4.
7. Press the Back Arrow key to exit the User Menu.

### **Browser Feature**

If you are unsure of the output number, refer to Appendix B at the back of this guide for a diagram showing you how to use the built-in Outputs ON/OFF browser.

### **Favorite**

Allows you to activate a Z-Wave Favorite. Z-Wave devices can be grouped together to create Favorites. Favorites can only be activated, or turned on. A separate Favorite must be created to change the conditions set by the first Favorite. For a complete description on how to add a Favorite to activate, see **Adding a FAVORITE** in Z-Wave Setup.

1. When FAVORITES? displays, press any Select key. The keypad displays FAVORITE: -.
2. Enter a Favorite number from 1-20. Pressing COMMAND activates the Favorite.

## Z-Wave Setup

Your system may include a DMP Z-Wave controller module attached at installation. The Z-Wave controller module allows short range radio control of Z-Wave devices that you or your installation company may provide such as lighting control modules, thermostat controls, and door locks. Z-Wave Setup allows you to program the system to control the Z-Wave devices. You may control your Z-Wave devices from your iPhone/iPad or Android device using the DMP Virtual Keypad App or from your keypad by activating a Favorite from the Favorites User Menu.

**Note:** Outputs On Off must be enabled in the profile assigned to the user to access Z-Wave Setup. See User Profiles in the User Menu.

The available setup options are: Add, List, Remove, Favorites, Transfer and Rediscover.

- Select ADD to add a Z-Wave device to your system.
- Select LIST to display a list of Z-Wave devices already added and stored in your system.
- Select REMOVE to completely remove a Z-Wave device from your system.
- Select FAV to Add, Edit or Remove a Favorite.
- Select XFER to transfer Z-Wave device information from another manufacturer's portable Z-Wave controller to your system.
- Select REDISC to require your system to rediscover and confirm radio communication with all of the added Z-Wave devices.

## Add Z-Wave Devices (ADD)

This option allows you to ADD a Z-Wave device to your system. Once added, a Z-Wave device may be assigned to a Favorite.

1. Access the User Menu.
2. Press COMMAND until ZWAVE SETUP? displays.
3. Press any Select key. The keypad displays ADD LIST REMOVE.
4. Select ADD. PROCESSING may briefly display. When PRESS BUTTON ON DEVICE TO ADD displays press the program button on the Z-Wave device. See the Z-Wave device's documentation for more information.
5. When the device information is received by the system, the keypad beeps once and displays DEVICE FOUND.
6. Once added, the keypad displays the type of device and the default device name. Press COMMAND.
7. Press any top row Select key and enter up to a 16 character custom name for the device. See Entering Names in Appendix D.
8. Press the COMMAND key to store the new name.

**Note:** A maximum of 232 Z-Wave devices can be added to the system. When the maximum number of devices have been added, the keypad displays ZWAVE TABLE FULL and no additional Z-Wave devices may be added without removing some existing devices.

## List Z-Wave Devices (LIST)

This option allows you to edit the name of a Z-Wave device or confirm radio communication with the Z-Wave device. When LIST is selected, the first Z-Wave device stored in the system is displayed. Remaining devices can be viewed by pressing the COMMAND key. Lighting control modules, are displayed first, followed by door locks and then thermostat controls.



The available LIST options are: Rename and Status.

- Select RENAME to enter up to 16 characters for a new device name.
- Select STATUS to confirm radio communication with the Z-Wave device.

#### RENAME Z-Wave Devices

1. Access the User Menu.
2. Press COMMAND until ZWAVE SETUP? displays.
3. Press any Select key. The keypad displays ADD LIST REMOVE.
4. Select LIST to display DEVICE LIST and the first Z-Wave device stored. Press the COMMAND key to advance through the list of Z-Wave devices.
5. Press any Select key to display DEVICE RENAME STATUS.
6. Select RENAME and enter up to 16 characters for a new device name. See Entering Names in Appendix D.
7. Press COMMAND to save the new Z-Wave device name and return to the DEVICE LIST.

#### STATUS of Z-Wave Devices

1. Access the User Menu.
2. Press COMMAND until ZWAVE SETUP? displays.
3. Press any Select key. The keypad displays ADD LIST REMOVE.
4. Select LIST to display DEVICE LIST and the first Z-Wave device stored. Press the COMMAND key to advance through the list of Z-Wave devices.
5. Press any Select key to display DEVICE RENAME STATUS.
6. Select STATUS to confirm radio communication with the Z-Wave device.
7. The device name and OKAY displays when the device stored in the system communicates.

8. Press the COMMAND key to return to the device list and display the next device in the list.
9. If the device stored in the system does not communicate, the device name and FAILED displays. Press the COMMAND key and REMOVE FAILED DEVICE displays.
10. Select YES to remove the failed device from the system memory. Select NO to leave the device in the system memory and to return to the device list.
11. When the device has been removed, the device name and REMOVED is displayed and the system no longer tries to communicate with the Z-Wave device.

### **Remove Z-Wave Devices (REMOVE)**

Each Z-Wave device added to your system remains in your system unless it is removed. This option allows you to remove Z-Wave devices from your system.

1. Access the User Menu.
2. Press COMMAND until ZWAVE SETUP? displays.
3. Press any Select key. The keypad displays ADD LIST REMOVE.
4. Select REMOVE. PROCESSING may briefly display. When PRESS BUTTON ON DEVICE TO REMOVE displays press the program button on the Z-Wave device, the device name and REMOVED is displayed to indicate the Z-Wave device has been removed.

## **Favorites (FAV)**

Z-Wave devices can be grouped together to create a Favorite. This option allows you to program up to 20 Favorites in your system and then ADD, EDIT OR REMOVE up to 25 Z-Wave devices in a Favorite. When activated from the FAVORITE user menu, a command is sent to its Z-Wave Devices. A Favorite can only be activated, or turned on. A separate Favorite must be created to change the conditions set by the first Favorite. For example, a Favorite called "Movie Night" could lock the exterior doors, close the garage door, adjust the temperature, and dim the lights in the family room to the desired level. Another Favorite called "Wakeup" could then turn on the lights, adjust the temperature, unlock the exterior doors, and raise the garage doors.

### **Adding a FAVORITE**

1. Access the User Menu.
2. Press COMMAND until ZWAVE SETUP? displays.
3. Press any Select key. The keypad displays ADD LIST REMOVE.
4. Press COMMAND again to display FAV XFER REDISC. Select FAV and FAVORITE NUMBER: - is displayed.
5. Enter a Favorite number between 1 and 20 and press COMMAND. If the Favorite number entered is unassigned, \*UNUSED\* displays. If the Favorite is already assigned, you may change the name or press the back arrow and enter a new number.
6. Press any Select key and a cursor displays. Enter a Favorite name up to 16 characters. To remove a Favorite, press Command without entering a name.
7. Press COMMAND to save the Favorite and the Favorite name and ADD EDIT REMOVE displays.

### **ADD Devices to FAVORITES**

1. Access the User Menu.
2. Press COMMAND until ZWAVE SETUP? displays.

3. Press any Select key. The keypad displays ADD LIST REMOVE.
4. Press COMMAND again to display FAV XFER REDISC. Select FAV and FAVORITE NUMBER: - is displayed.
5. Enter a Favorite number between 1 and 20 and press COMMAND.
6. The Favorite number and name displays. Press COMMAND and the Favorite Name and ADD EDIT REMOVE displays.
7. Select ADD and the first Z-Wave device stored in the system that has not already been added to this Favorite is displayed. Remaining devices can be viewed by pressing the COMMAND key.
8. Press any Select key to assign the displayed device to the Favorite. The device name and the current device settings display. When added to a Favorite, a Z-Wave device can be programmed to respond to various ON/OFF/LOCK/UNLOCK/HEAT/COOL commands based on your desired settings. To change a device setting, See Device Settings in Favorites.

### **Device Settings in FAVORITES**

#### **Lights**

1. Press any Select key at SETTING: and ON OFF DIM displays. Press the Select key under the desired setting.
2. For ON or OFF setting, when selected, the Favorite name and the next Z-Wave device stored in the system displays.
3. For DIM setting, DIM LEVEL: with the current setting displays. To change the setting, press any Select key and enter the new level (1 - 10) and Press COMMAND.
4. The Favorite name and the next Z-Wave device stored in the system displays.

## Locks

1. Press any Select key at SETTING: and LOCK UNLOCK displays. To change the setting, press the Select key under the new setting.
2. The Favorite name and the next Z-Wave device stored in the system displays.

## Thermostats

1. Press any Select key at SYSTEM: and OFF CL HT displays. To change the setting of OFF, COOL or HEAT, press the Select key under the new setting.
2. Select OFF to display FAN SETTING:.
3. Press any Select key and ON AUTO displays. Press the Select key under the desired new setting to change.
4. Select CL to display COOL.
5. To change the setting, press any Select key, enter the new temperature and press COMMAND.
6. Press any Select key and the keypad displays FAN SETTING:.
7. Press any Select key and ON AUTO displays. Press the Select key under the desired new setting to change.
8. Select HT to display HEAT.
9. To change the setting, press any Select key and enter the new temperature and Press COMMAND.
10. Press any Select key and the keypad displays FAN SETTING:.
11. Press any Select key and ON AUTO displays. Press the Select key under the desired new setting to change.
12. The Favorite name and the next Z-Wave device stored in the system displays.

**Note:** A maximum of 25 devices can be assigned to each Favorite. When attempting to add a device and the maximum number of devices has been assigned, FAVORITE FULL is displayed. No additional Z-Wave devices may be added to this Favorite, however a new Favorite may be created and devices added to the new Favorite.

## EDIT Devices in FAVORITES

1. Access the User Menu.
2. Press COMMAND until ZWAVE SETUP? displays.
3. Press any Select key. The keypad displays ADD LIST REMOVE.
4. Press COMMAND again to display FAV XFER REDISC. Select FAV and FAVORITE NUMBER: - is displayed.
5. Enter a Favorite number between 1 and 20 and press COMMAND.
6. The Favorite number and name displays. Press COMMAND and the Favorite Name and ADD EDIT REMOVE displays.
7. Select EDIT and the first Z-Wave device stored in the Favorite displays. Remaining devices can be viewed by pressing the COMMAND key.

**Note:** Z-Wave devices are displayed by device type; Lights first, followed Locks, and Thermostats last. By pressing the COMMAND key you can scroll through the devices assigned to the selected Favorite.

8. Press any Select key to display the device name and the setting for the device.
9. To change the setting, See Device Settings in Favorites.
10. Once the device settings have been entered, the Favorite name and the next Z-Wave device stored in the selected Favorite displays.

## REMOVE Devices from FAVORITES

1. Access the User Menu.
2. Press COMMAND until ZWAVE SETUP? displays.
3. Press any Select key. The keypad displays ADD LIST REMOVE.
4. Press COMMAND again to display FAV XFER REDISC. Select FAV and FAVORITE NUMBER: - is displayed.
5. Enter a Favorite number between 1 and 20, press COMMAND.
6. The Favorite number and name displays. Press COMMAND and the Favorite Name and ADD EDIT REMOVE displays.
7. Select REMOVE and the first Z-Wave device stored in the Favorite displays. Remaining devices can be viewed by pressing the COMMAND key.
8. Press any Select key to remove the device from the Favorite. REMOVE DEVICE FROM FAV? NO YES displays. When YES is selected, the device is removed from the Favorite.

## Transfer Controller (XFER)

This option allows the transfer of all existing Z-Wave devices that are currently programmed in another manufacturer's Z-Wave portable controller to your system.



This operation will overwrite all Z-Wave devices that are programmed in your system. This option typically occurs at the time your DMP Z-Wave controller is installed.

Initiate the transfer at the other manufacturer's Z-Wave portable controller after starting the transfer on the DMP keypad. Z-Wave devices are NOT overwritten until the transfer has been initiated at the other manufacturer's Z-Wave portable controller. The transfer should not be stopped once the process has been initiated from the other manufacturer's Z-Wave portable controller.

### Transfer Operation:

1. Access the User Menu.
2. Press COMMAND until ZWAVE SETUP? displays.
3. Press any Select key. The keypad displays ADD LIST REMOVE.
4. Press COMMAND again to display FAV XFER REDISC. Select XFER. The keypad displays XFER WILL DELETE EXISTING DEVICES then displays XFER CNTRL SURE? YES NO.
5. Select YES to allow receipt of Z-Wave devices to your system. The keypad displays TRANSFERRING Z-WAVE DEVICES. Pressing the Back Arrow key cancels the transfer.  
Select NO to exit the XFER menu and return to ZWAVE SETUP?. All programming will still be intact on the DMP Z-Wave controller and will cancel the transfer.

6. Initiate the transfer at the other manufacturer's Z-Wave portable controller. All Z-Wave devices are added to the system with a default name (device type and number). A 16-character name may be assigned to the Z-Wave devices after the transfer is complete. When the transfer is complete the screen will display ZWAVE SETUP?.

**Note:** If TRANSMISSION FAILED displays on the screen, your system memory is cleared of all prior Z-Wave devices programming and will need to add each Z-Wave device individually.

### Rediscover (REDISC)

This option allows your system to search for and re-establish communication with Z-Wave devices that may have failed to communicate. Only Z-Wave devices already programmed into your system are included in the rediscovery search. Any programmed Z-Wave device that is not found during rediscovery will be deleted from your system.

1. Access the User Menu.
2. Press COMMAND until ZWAVE SETUP? displays.
3. Press any Select key. The keypad displays ADD LIST REMOVE.
4. Press COMMAND again to display FAV XFER REDISC.
5. Select REDISC, the keypad displays REDISCOVERING ZWAVE DEVICES while the system is searching for Z-Wave devices.
6. When the rediscovery is complete, the keypad returns to ZWAVE SETUP?

### Zone Status

Displays a list of armed, bypassed, or alarmed zones. Also allows you to check the status of individual zones. Zone Status can be used to give you a list of zones by category or display the current status of an individual zone number. The four categories are:

- Armed Zones - zones that are currently armed.
- Bypassed Zones - zones that are currently bypassed.
- Alarmed Zones - zones that have gone into alarm during the current or previous armed period.
- Number - enter the number of any zone to check its status.

### Using the Zone Status Function

1. Access the User Menu.
2. Press COMMAND until ZONE STATUS? displays.
3. Press any Select key to display ARM BYPS ALR NBR.
4. Select ARM for a list of zones that are currently armed. You can scroll through the list by pressing the COMMAND key.
5. Select BYPS for a list of zones that are currently bypassed.
6. Select ALR for a list of zones that have gone into alarm during the current or previous armed period.
7. Press NBR and ZONE NO: - displays.
8. At the ZONE NO: - option, enter the zone number you want to check and press COMMAND.

The zone number and name display followed by the zone status. For example, a zone status for zone 1 might be BACK DOOR - OKAY.

Below is a list of the zone status displays:

-OKAY = the zone is in a normal condition

-BYPAS = the zone is bypassed

-BAD = the zone is in a bad or faulted condition

9. After displaying the zone status, ZONE: - returns for you to enter another zone number.

## Browser Feature

If you are unsure of the zone number or description, refer to Appendix B at the back of this guide for a diagram showing you how to use the built-in Zone Status browser.

## Bypass Zones

Allows you to bypass a zone prior to arming.

Bypassing is usually done when a zone cannot be restored to normal. A significant benefit of bypassing a zone is to allow a zone in a faulted or bad condition to be bypassed so arming can occur.

The faulted zone can be serviced the next day.

A zone can be bypassed only while it is disarmed. Fire, panic, emergency, and supervisory type zones are always armed, so they can never be manually bypassed.

Bypass Zones can also be used to reset a zone that has been bypassed and restore it back into the system.

When Bypass Zones is selected, a report can be transmitted to your central station.

During arming, when choosing to bypass a zone or device, there **may** be a pre-programmed maximum number of zones (up to 8) that can be bypassed in an area. This limit is programmed at installation.

## Using the Bypass Zones Function

1. Access the User Menu.
2. Press COMMAND until BYPASS ZONES? displays.
3. Press any Select key. The keypad displays ZONE: - RST BYPS.
4. To Bypass a zone, enter the zone number and select BYPS. The zone number automatically disappears and a new zone number can be entered. Refer back to step 3.
5. To Reset a zone, enter the zone number and select RST.

## Browser Feature

If you are unsure of the zone number or description, refer to Appendix B at the back of this guide for a diagram showing you how to use the built-in Bypass Zones browser.

## Zone Monitor

Allows the system to monitor selected disarmed zones (doors, windows, or motion detectors) and display their name at the keypad as they are faulted. This feature could be used to monitor an access door.

Zone Monitor works with any disarmed zone and also sounds the keypad monitor tone when the zone faults. The zone name displays at all keypads designated for the area in your system.

You can place any combination of disarmed zones in Zone Monitor but only the most recent zone faulted displays. The displayed zone name clears automatically after a short time or when the zone is armed.

## Monitor (Chime) Shortcut Key

**All Systems** — Press 5 for 2 seconds when the system is disarmed. This initiates the Zone Monitor operation for all Exit zones in an Area system or all zones assigned to the perimeter in a Home/Sleep/Away, Home/Sleep/Away with Guest, or All/Perimeter system. The keypad displays MONITOR ON and chimes or displays MONITOR OFF and no tone is sounded.

## Testing your system's burglary protection

After using the System Test function, place all zones in Zone Monitor. Starting at the front door, go around and open and then close each door and window. You should hear the keypad beep each time. The keypad also displays the name of each zone as its device is opened.

Once the protected doors and windows test is complete, walk in front of each motion detector. The keypad should beep to confirm the zone has tripped. If at any time during your weekly testing a device does not cause the keypad to beep, call the service department for assistance.

## Using the Zone Monitor Function

1. Access the User Menu.
2. Press COMMAND until ZONE MONITOR? displays.
3. Press any Select key. The keypad displays ALL NBR or PERIM ALL NBR.
4. Select PERIM to place all disarmed perimeter zones into Zone Monitor.
  - 4a. The keypad displays ALL? ADD RMV.
  - 4b. Select ADD to add all disarmed zones to Zone Monitor.
  - 4c. Select RMV to remove all disarmed zones.
5. Select ALL to place all disarmed zones into Zone Monitor.
  - 5a. The keypad displays ALL? ADD RMV.
  - 5b. Select ADD to add all disarmed zones to Zone Monitor.
  - 5c. Select RMV to remove all disarmed zones.
6. Select NBR to enter a specific zone number for zone monitor.
  7. If you select NBR, the keypad displays ZONE: - ADD RMV.
    - 7a. Enter any zone number and select ADD to add this zone.
    - 7b. Enter any zone number and select RMV to remove this zone.
  8. The zone number automatically disappears. You can then enter a new zone number and repeat step 7a or 7b.

## Browser Feature

If you are unsure of the zone number or description, refer to Appendix B at the back of this guide for a diagram showing you how to use the built-in Zone Monitor browser.

## System Status

Displays the current condition of internal system hardware.

System Status shows the panel condition of AC power, battery power, and optional panel tamper. When System Status is selected, each monitor displays followed by OKAY or TRBL (Trouble) to indicate the current condition.

## Using the System Status Function

1. Access the User Menu.
2. Press COMMAND until SYSTEM STATUS? displays.
3. Press any Select key. The display starts listing each system monitor and status.

For example: AC POWER - OKAY

Below are the System Monitor displays:

| <b>Keypad Display</b> | <b>What it monitors</b> |
|-----------------------|-------------------------|
|-----------------------|-------------------------|

|          |          |
|----------|----------|
| AC POWER | AC power |
|----------|----------|

|         |               |
|---------|---------------|
| BATTERY | Battery power |
|---------|---------------|

|        |                  |
|--------|------------------|
| TAMPER | Panel box tamper |
|--------|------------------|

These are followed by either OKAY or TRBL (trouble).

If TRBL displays, call the service department for assistance.

4. The system then displays its firmware version, and then exits the User Menu.

For example: VER\_118\_1/20/13 MODEL XR550

## System Test

System Test is used to test the battery, alarm bell or siren, and communication to a central station. The System Test function begins automatically as soon as you select it.

**Note:** If an area is in an armed state, the system test will not operate.

## Using the System Test Function

1. Access the User Menu.
2. Press COMMAND until SYSTEM TEST? displays.
3. The keypad displays SYSTEM PANICS. Select SYSTEM.
3. The System Test begins automatically and the keypad displays the following messages in this order:
  - 1) **BELL SOUNDING** during a two second bell test
  - 2) **KEYPAD SOUNDING** all keypads assigned to the same area sound their burglary alarm tone for two (2) seconds during the keypad sounder test
  - 3) **BATTERY - OKAY** or **BATTERY - TRBL** to indicate the battery condition
  - 4)\***TRANSMIT TEST NO: 1** during the transmit test
  - 5) **TRANSMIT OKAY** or **TRANSMIT FAILED** to show the results of the transmit test
  - 6) **TEST END** to indicate the System Test is complete.
  - 7) You can press the Back Arrow key to end the transmit test.
    - \* The transmit test does not occur on local systems.

## Using the Panic Zone Test (XR550N/E Only)

1. Access the User Menu.
2. Press COMMAND until SYSTEM TEST? displays.
3. Press any Select key. The keypad displays SYSTEM PANICS.
4. Select PANICS.
5. The Panic Zone Test begins automatically and the keypad displays TRIPS: END.

During the Panic Zone Test, trip each panic zone (or button) by pressing and holding the panic for 1 to 2 seconds.

**Note:** You do NOT have to hold the panic for 2 seconds in normal mode. The Panic Zone Test takes additional time to display when the system is in test mode.

Each time you trip a panic zone, the display number increments and the keypad buzzer sounds for two seconds.

The number of panic zones tripped constantly displays until the test ends or no panic zone activity has occurred for 20 minutes.

6. Select END to stop the Panic Zone Test.
7. PANIC TEST OKAY displays when the Panic Zone Test is completed and all zones tested OK.
8. When the Panic Zone Test ends and a zone failed (did not trip) during the test, the keypad displays the zone name and number and the buzzer sounds for one second. Press the COMMAND key to display the next failed zone.

**Note:** If testing a key fob, a message will not display if it fails, only the verification message is displayed.

**Note:** During the Panic Zone Test, any zones that fail are not sent to the receiver unless pre-programmed at installation to be sent.



**Note:** Your system may be programmed to limit the Panic Zone Test to only be performed during the Area 32 schedule.

## User Profiles

Add, delete, or change User Profiles, that define the authority of each user code in the system. Several characteristics define the authority of each User Profile within the system. Always make sure that at least one administrator in your system has a profile with **all** authorities and **all** areas. Up to four profiles may be assigned per user.

In All/Perimeter or Home/Sleep/Away operation, User Profiles will not display in the User Menu. When adding User Codes, use the default profiles 1 through 10. Refer to the User Profiles Chart.

In Home/Sleep/Away with Guest operation, the User Profiles option does not display in the User Menu but when adding User Codes, enter a profile number 1 through 9 for the main house system, profiles 11-19 for the Guest 1 house system, and profiles 21-29 for the Guest 2 house system (XR550 only). Profiles 2-9 will default to have Arming/Disarming for all eight areas, while profiles 12-19 and 22-29 only have Arm/Disarm assigned to Guest 1 and Guest 2 respectively. Profiles 1, 11, and 21 do not have any Arming/Disarming authority assigned. Refer to the User Profiles Chart.

**Profile Number** - Each profile may be assigned a unique number from 1 to 99.

**Profile Name** - Each profile may be assigned a 32-character name. The Profile Number is the default name.

**Area Number** - Each profile may be assigned specific areas of the system for arming and disarming. When profiles 1 to 98 are created, NO areas are assigned by default. The default for profile 99 is ALL areas assigned. Profile 99 is predefined in the system by the factory. For the XR150 Series system you can assign areas 1 to 8. For the XR350 Series panel you can assign areas 1 to 16 and in an XR550 Series system you can assign areas 1 to 32.

**Access Area Number** - Each profile may be assigned door access area assignments. Default for profile 1 to 98 is NO areas assigned. Default for profile 99 is ALL areas assigned. Profile 99 is predefined at the factory.

**Output Group Assignment** - Each profile may be assigned an output group number from 1 to 10. Default for profile 1 to 98 is NO output group assigned. Default for profile 99 is output group 10. Your system may be programmed to turn on an output group at certain keypads when door access occurs.

**User Menu Assignments** - Each user profile may have any of the menus assigned to it as shown in the User Profile Record. The User Profile Record lists the user menu profile assignments and the system functions users are allowed to access based on the profile numbers assigned to their codes.

## Adding User Profiles

1. Access the User Menu. Press COMMAND to USER PROFILES?.
2. Press any Select key. The keypad displays ADD DEL CHG. Select ADD to add a new user profile.
3. At the PROFILE NO: - option, enter an unused profile number and press COMMAND. The display changes to PROFILE NAME.
4. Press any Select key. Enter a profile name of up to 32 characters. Press COMMAND. See Appendix B.
5. At the ARM/DIS AREAS: option, select the area numbers for arming and disarming assigned to this profile.
6. The keypad displays ACCESS AREAS: . Select the area numbers assignment to allow door access for this profile. Press the COMMAND key.
7. The keypad displays OUTPUT GROUP: -. Enter the number for the Output Group assigned to this profile. Press the COMMAND key.

8. The keypad displays each of the menus as shown in the Profile Table for you to enable for this profile number. Select YES or NO and press the COMMAND key to advance to the next menu Selection.
9. When you have completed selecting all User Profile menu assignments, the keypad displays the PROFILE ## ADDED message for 4 seconds.

## Browser Feature

Refer to Appendix B in this guide for a diagram showing you how to use the Add User Profiles browser.

## Changing User Profiles

1. Access the User Menu.
2. Press COMMAND until USER PROFILES? displays.
3. Press any Select key. The keypad displays ADD DEL CHG.
4. Select CHG to change a user profile.
5. At the PROFILE NO: - option, enter a profile number and press COMMAND. The display changes to PROFILE NAME.  
**Note:** The panel's authority check determines whether your User Profile is authorized to change another profile. The message NO AUTHORITY appears if you are not authorized to change the profile.
6. Press any Select key to display -. Enter a profile name of up to 32 characters. The default Profile Name uses the Profile Number. Enter the name and press COMMAND.
7. At the ARM/DIS AREAS: option, enter the area numbers for arming and disarming assigned to this profile.
8. The keypad displays ACCESS AREAS: . Enter the area numbers assignment to allow door access for this profile. Press the COMMAND key.
9. The keypad displays OUTPUT GROUP: -. Enter the number for the Output Group assigned to this profile. Press the

COMMAND key.

10. The keypad displays each of the menus as shown in the Profile Table. You then enable or disable the menu function for this profile number. Select YES or NO and press the COMMAND key to advance to the next menu selection.
11. When you complete Selecting all User Profile menu assignments, the keypad displays the PROFILE CHNGD message for 4 seconds, indicating the profile is changed.

## Browser Feature

Refer to Appendix B in this guide for a diagram showing you how to use the Change User Profiles browser.

## Deleting User Profiles

1. Access the User Menu.
2. Press COMMAND until USER PROFILES? displays.
3. Press any Select key. The keypad displays ADD DEL CHG.
4. Select DEL to delete a user profile.
5. At the PROFILE NO: - option, enter a profile number and press COMMAND. The display changes to DELTD.

**Note:** User codes assigned to deleted profiles will not function.

## Browser Feature

Refer to Appendix B in this guide for a diagram showing you how to use the Delete User Profiles browser.

## TEMP CODE

When you select YES for this menu option, the keypad displays EXPIRATION DATE?. Enter the ending date for the profile to expire. The keypad displays EXPIRATION TIME?. Enter the ending time for the profile to expire. The keypad displays USER CODE?. Enter a user code to activate.

## **ANTI PASS NO**

Anti-passback requires that you properly exit (egress) an area previously accessed. If you fail to exit through the proper location you cannot access it until you properly exit. Default is No. See Failed to Exit (Anti-Passback) for more information.

## **EASY ARM/DISARM?**

When entering your code, Easy Arm/Disarm allows you to automatically arm or disarm all areas that are assigned to your code. The ALL NO YES? option does not display when this option is enabled.

## **ACCESS SCHEDULES**

This option allows you to assign up to eight Schedules to a profile for door access. When the keypad displays FIRST ACCESS SCHEDULE: - press any of the first three Select keys to enter the desired Schedule number. Press the fourth Select key to browse available Schedules in the LIST option. Press the Select key under the desired Schedule to display the Schedule number then press COMMAND. The keypad displays SECOND ACCESS SCHEDULE: - repeat the same process for the third through eighth access schedule and press COMMAND to return to the User Menu.

**Note:** To program a profile with anytime access, do not assign the profile number to any Schedules.

## **RE ARM DELAY**

RE ARM DELAY allows the entry of 0 to 720 minutes to be used to delay automatic rearming when the user disarms an area outside of schedule. If zero is selected, the rearming occurs based on permanent programming in the panel. If another user enters a valid user code or credential after the RE ARM DELAY countdown has started, and their user profile RE ARM DELAY is greater, then the RE ARM DELAY countdown starts over with the new time.

RE ARM DELAY is also used to delay a late to close message to the central station when the panel does not use automatic arming.

If the user has Extend Schedule authority, 2HR 4HR 6HR 8HR displays at disarming. If the user does not make a choice, the RE ARM DELAY is used to extend the schedule.

Application example: An exit door near the trash is scheduled to be armed at all times. When the custodian needs to remove trash, program 10 minutes for the activity. Or, an overhead door only requires access when a delivery is made. Program up to 720 minutes to allow the loading dock supervisor to load or unload a semi-truck.

## **USE SECONDARY LANGUAGE**

This option allows you to set the programmed secondary user language to display when the Easy Arm/Disarm option is enabled and the user presents their credential or enters their user code at the Status List.

## User Profiles Chart

**Note:** For All/Perimeter or Home/Sleep/Away systems use the default profiles 1 through 10. For Home/Sleep/Away with Guest systems use the default profiles 1 through 9 for the main house system, default profiles 12-19 for the Guest 1 house system, and default profiles 22-29 for the Guest 2 house system. Profiles 12-19 and 22-29 default to the same privileges as profiles 2-9. For example, profile 13 and 23 have the same privileges as profile 3.

| Menu Display     |           |     | Privilege          | Predefined Profile Number |     |     |     |     |     |     |     |     |     |       |    |     |
|------------------|-----------|-----|--------------------|---------------------------|-----|-----|-----|-----|-----|-----|-----|-----|-----|-------|----|-----|
|                  |           |     |                    | 1                         | 2   | 3   | 4   | 5   | 6   | 7   | 8   | 9   | 10  | 11-98 | 99 |     |
| ALM SLNC         | NO        | YES | Alarm Silence      | No                        | Yes | Yes | Yes | Yes | Yes | Yes | Yes | Yes | Yes | No    | No | Yes |
| SNSR RST         | NO        | YES | Sensor Reset       | Yes                       | Yes | Yes | Yes | Yes | Yes | Yes | Yes | Yes | Yes | No    | No | Yes |
| LOCKDOWN         | NO        | YES | Lockdown           | Yes                       | Yes | Yes | Yes | Yes | Yes | Yes | Yes | Yes | Yes | Yes   | No | Yes |
| DOOR LOCK/UNLOCK | NO        | YES | Door Lock/Unlock   | Yes                       | Yes | Yes | Yes | Yes | Yes | Yes | Yes | Yes | Yes | Yes   | No | Yes |
| DOOR ACS         | NO        | YES | Door Access        | Yes                       | Yes | Yes | Yes | Yes | Yes | Yes | Yes | Yes | Yes | Yes   | No | Yes |
| ARM AREA         | NO        | YES | Armed Areas        | Yes                       | Yes | Yes | Yes | Yes | Yes | Yes | Yes | Yes | Yes | No    | No | Yes |
| OUTPUTS          | NO        | YES | Outputs ON/OFF     | No                        | No  | No  | No  | Yes | Yes | Yes | Yes | Yes | Yes | No    | No | Yes |
| FAVORITES        | F01 – F20 |     | Z-Wave Favorites   | No                        | No  | No  | No  | Yes | Yes | Yes | Yes | Yes | Yes | No    | No | Yes |
| ZN STATS         | NO        | YES | Zone Status        | Yes                       | Yes | Yes | Yes | Yes | Yes | Yes | Yes | Yes | Yes | No    | No | Yes |
| BYPAS ZN         | NO        | YES | Bypass Zones       | No                        | No  | No  | No  | No  | Yes | Yes | Yes | Yes | Yes | No    | No | Yes |
| ZONE MON         | NO        | YES | Zone Monitor       | No                        | No  | No  | Yes | Yes | Yes | Yes | Yes | Yes | Yes | No    | No | Yes |
| SYS STAT         | NO        | YES | System Status      | Yes                       | Yes | Yes | Yes | Yes | Yes | Yes | Yes | Yes | Yes | No    | No | Yes |
| SYS TEST         | NO        | YES | System Test        | No                        | No  | No  | Yes | Yes | Yes | Yes | Yes | Yes | Yes | No    | No | Yes |
| PROFILES         | NO        | YES | User Profiles      | No                        | No  | No  | No  | No  | No  | No  | No  | Yes | No  | No    | No | Yes |
| USR CODE         | NO        | YES | User Codes         | No                        | No  | No  | No  | No  | No  | No  | No  | Yes | No  | No    | No | Yes |
| EXTEND           | NO        | YES | Extend Schedules   | No                        | No  | No  | No  | No  | Yes | Yes | Yes | Yes | Yes | No    | No | Yes |
| SCHEDULS         | NO        | YES | Schedules          | No                        | No  | No  | No  | No  | No  | Yes | Yes | Yes | Yes | No    | No | Yes |
| TIME             | NO        | YES | Time               | No                        | No  | No  | No  | No  | No  | No  | Yes | Yes | Yes | No    | No | Yes |
| DIS EVNT         | NO        | YES | Display Events     | Yes                       | Yes | Yes | Yes | Yes | Yes | Yes | Yes | Yes | Yes | No    | No | Yes |
| SERV REQ         | NO        | YES | Service Request    | No                        | No  | No  | No  | No  | No  | No  | Yes | Yes | Yes | No    | No | Yes |
| FIRE DRILL       | NO        | YES | Fire Drill         | No                        | No  | No  | No  | No  | No  | No  | Yes | Yes | Yes | No    | No | Yes |
| TEMP CODE        | NO        | YES | Temp User Code     | No                        | No  | No  | No  | No  | No  | No  | No  | No  | No  | No    | No | No  |
| ANTI PASS        | NO        | YES | Anti-Passback      | No                        | No  | No  | No  | No  | No  | No  | No  | No  | No  | No    | No | No  |
| ACCESS SCHEDULES | Sch. 1-99 |     | Access Time        | -                         | -   | -   | -   | -   | -   | -   | -   | -   | -   | -     | -  | -   |
| RE ARM DLY       | 0 – 720   |     | Re-Arm Delay       | No                        | No  | No  | No  | No  | No  | Yes | Yes | Yes | Yes | No    | No | Yes |
| EASY ARM/DISARM  | NO        | YES | Arm/Disarm         | No                        | No  | No  | No  | No  | No  | No  | No  | No  | No  | No    | No | No  |
| SEC LANGUAGE     | NO        | YES | Preferred Language | No                        | No  | No  | No  | No  | No  | No  | No  | No  | No  | No    | No | No  |

## User Codes

This option allows you to add, delete, or change a user code. You may also assign specific User Profiles to individual users.

1234 = User Number  
34812 = User Code  
89456 = PIN  
John Smith = User Name  
7 = Profile

**User Number** - Every user is numbered 1 through 9999. This number identifies the user to the system and is transmitted to the central station when the user arms or disarms areas.

**User Code** - Each user also has a 3- to 6-digit number to 999999, to enter into the keypad when arming or disarming the system. Only 4-digit user codes can be assigned to All/Perimeter, Home/Sleep/Away, or Home/Sleep/Away with Guest system users.

**Note:** A User Code cannot begin with zero and 3-digit codes cannot begin with 98.

**PIN** - In an XR550E Card Plus PIN system, each user is assigned a unique PIN (up to 6 digits) to enter into the keypad after presenting their card/proximity credential to the reader when accessing system functions.

**User Names** - Each code may also be programmed with the user name. You may enter up to 32 characters for the name. As needed, refer to Appendix C for Entering User Names information.

**User Profile** - The user is also assigned a Profile (1 to 99) by the person administrating the system. The profile number determines the areas and functions the user can access.

## Adding User Codes

1. Access the User Menu.
2. Press COMMAND until USER CODES? displays.
3. Press any Select key. The keypad displays ADD DEL CHG BAT.
4. Select ADD or BAT (Batch) to add a new user code.
5. At the USER NUMBER: - option, enter a user number and press COMMAND. The display changes to USER CODE: - .

**Note:** Do NOT program a code for user number 1 unless you intend to use the Ambush function. See Ambush.

6. Enter a user code of 3 to 6 digits and press COMMAND. The user enters this number to arm, disarm, etc. If using access cards, present the card instead of entering a code. After entering the code the keypad displays USER NUMBER ### as the user name.
7. A 32-character name may be entered to identify the user. Press any top row key to clear the current name. You may then enter the new name. After entering the name press COMMAND. See Entering Names in Appendix D.
8. The display changes to PROFILE NO: -. Select the profile number to assign a set of authorized functions to the user code as outlined in the Profile Table on the previous page. Up to four profile numbers can be assigned to each user.

**Note:** On All/Perimeter or Home/Sleep/Away systems use the default profiles 1 through 10. For Home/Sleep/Away with Guest systems use the default profiles 2 through 9 for the main house system, default profiles 12-19 for the Guest 1 house system, and default profiles 22-29 for the Guest 2 house system.

9. At the PROFILE NO: - display, enter a profile number from 1 to 99, and press COMMAND. The display shows USER # ADDED.

**Note:** If BAT (Batch) was chosen in step 4 instead of ADD, the next available user number is automatically selected and only steps 6 and 7 repeat. The User Profile assignment is automatically selected for the next user based on the previous user entered. This batch entry method speeds up user entry in large systems.

## Browser Feature

Refer to Appendix B at the back of this guide for a diagram showing you how to use the Add User Codes browser.

## Changing User Codes

To change a user code, you must have a user code with a profile that has user code authority.

1. Access the User Menu.
2. Press the COMMAND key until USER CODES? displays.
3. Press any Select key. The keypad displays ADD DEL CHG BAT.
4. Select CHG to change a user code.
5. At the USER NUMBER: - option, enter the user number to change and press COMMAND.

Refer to the System Setup section for the number of user codes available for your system.

6. The display changes to USER CODE: \* \* \* \* \*. Press any Select key and enter the new user code. Press COMMAND.
7. The display then shows the current user name. Press any top row key to clear. See Entering Names in Appendix D to enter a new name.

**Note:** Changing a user code does not change the user number.

8. The display changes to PROFILE NO: -. Select the profile number to assign a set of authorized functions to the user code as outlined in the Users Profile Chart.
9. After entering the profile number, the keypad displays USER # CHANGED for five seconds followed by USER NUMBER: -. This display allows you to enter another user number to change. Press the Back Arrow key twice to exit the User Menu.

## Changing Own User Code

Your system may be programmed at installation to allow users to change their own user code.

1. Access the User Menu.
2. Press the COMMAND key until USER CODES? displays. Press any Select key.
3. The display changes to USER CODE: \* \* \* \* \*. Press any Select key.
4. Type your new user code. Press Command.

## Browser Feature

Refer to Appendix B for diagrams showing you how to use the Change User Codes browser.

## Deleting User Codes

1. Access the User Menu.
2. Press COMMAND until USER CODES? displays.
3. Press any Select key. The keypad displays ADD DEL CHG BAT.
4. Select DEL to delete a user code from the system. To delete a user code, you must have a user code with a profile that has user code authority.

**Note:** Your system must have at least one user with user code authority in order to be able to add or delete user codes. Be careful not to delete all users with user code authority from your system. Also, the user code used to enter the user menu to delete codes cannot be deleted. In other words, you can not delete yourself.

5. At the USER NUMBER: - option, enter the user number you want to delete and press COMMAND. The display changes to USER # DELETED.
6. The display then changes back to USER NUMBER: - allowing you to delete another user. Press the Back Arrow key twice to exit the User Menu.

## Browser Feature

Refer to Appendix B at the back of this guide for a diagram showing you how to use the Delete User Codes browser.

## Sending User codes to Z-Wave locks

Your system may be pre-programmed at installation to support Z-Wave door locks. This option allows you to send user codes of user numbers 2-20 to all compatible Z-Wave locks. Once codes have been received by the lock, a valid user code entered at the lock (by user number 2-20) will lock the door or unlock and disarm the system according to the user's privileges.

1. Access the User Menu.
2. Press the COMMAND key until USER CODES? displays.
3. Press any Select key. The keypad displays ADD DEL CHG BAT. Press COMMAND again to display FRGV SEND.
4. Select SEND to send user codes of user numbers 2-20 to all compatible Z-Wave locks on your system. The keypad displays the progress of user codes being sent. The process may take several minutes.
5. If all locks receive the user codes, the display will return to the Status List.
6. If a lock does not receive the user codes, the keypad displays CODES NOT SENT TO ALL LOCKS.

## Forgive Failure to Exit

Failure to Exit is an Anti-passback violation in which a user assigned with anti-passback has attempted to re-enter an area that they did not exit through.

Forgive Failure to Exit removes the anti-passback violation. See Failed to Exit (Anti-Passback) for more information.

1. After the USER CODES? menu is accessed and ADD DEL CHG BAT displays. Press COMMAND again to display FRGV SEND.
2. Select FRGV to forgive the Failure to Exit and press COMMAND.
3. At the USER NUMBER:- option, enter the user number to be forgiven and press COMMAND. The User Code Browser described in Appendix B can help find the appropriate user by name if you do not know the number.
4. The keypad displays USER XXXX FORGVN to confirm, then returns to step 3 for the next user. Press the Back Arrow key to exit this menu.



## Ambush Code

Your system may be programmed to allow user number 1 to be used as an Ambush code. This Ambush code functions identically to a standard code with the exception that it sends a silent alarm to the central station. This silent alarm alerts the operator to a duress situation at the premises and prompts immediate notification of authorities.

Refer to the System Setup section of this guide to see if your system is programmed for Ambush. If so, do NOT program a code for user number 1 unless you intend to use the Ambush function.

## Extend Closing

Extending schedules allows the Closing Check operation to delay until the new closing time expires. This allows the current schedule to ignore its closing time and not send a LATE TO CLOSE message to the central station. This function is designed to allow workers to stay later and does not extend door access authority. The extended schedule erases when it expires.

1. Press any top row Select key at the EXTEND CLOSING option to program Extended Schedules.
2. The keypad displays ENTER CLOSE TIME -: AM PM. Enter a time to extend the current Closing Check open period.
3. To select AM or PM press the Select key under the desired option. Press COMMAND to exit the menu.

Note: If the system is not armed by the scheduled closing time, a Late to Close report is sent to the central station. If the schedule is extended, a Schedule Change report is sent to the central station.

## Schedules

Schedules are ideal for individual area auto arming and disarming and for creating Opening/Closing windows during which users can access the building or disarm the system.

The Schedules function allows you to program into the system the times at which you normally turn your burglary protection on and off each day of the week. Your system may be pre-programmed at installation to allow automatic arming and disarming. When pre-programmed, you can enter a schedule for the arming and disarming times.

If your system does not use automatic arming, you can use the Closing Check/Extend feature with Schedules to help ensure your system is armed manually at a specific time. This option sounds the keypad buzzer and displays CLOSING TIME! or AREA LATE! when a schedule expires. This reminds users still on the premises to arm the system or extend the schedule to a later time.

Your system provides you with the following schedules menus:

1. **Times** allows you to create schedules 01-99 with days of the week, begin/end times, and holidays.
2. **Areas** allows you to assign areas to pre-programmed schedules set in the TIMES menu.
3. **Door** allows you to choose doors to assign schedules set in the TIMES menu.
4. **Output** allows you to choose an output to schedules set in the TIMES menu.
5. **Holiday** dates allow you to enter special dates that activate Holiday Schedules that supersede all other schedules.
6. **Favorites** allows you to activate a Z-Wave Favorite (1-20).

## Setting Schedules

1. Access the User Menu and press COMMAND until SCHEDULES? displays. Press any Select key.
2. The keypad displays TIMES AREAS DOOR. Press COMMAND to display OUTPUT HOLIDAYS. Press COMMAND to display FAVORITES. Select the function you want to program.

## TIMES

The keypad displays ADD DEL CHG.

### Adding a Schedule

Select ADD to enter a new schedule number.

1. Enter the Schedule number 01-99 that you want to add. Press the COMMAND key to accept your Selection. You are then given the option to enter a Schedule name. Press COMMAND to proceed.
2. The keypad displays SUN MON TUE WED. Press the COMMAND key to display THU FRI SAT HOL. Select the day you want the schedule to begin. If you select HOL, go to Setting Holiday ABC Schedules for additional instructions.

**Note:** After Selecting the day of the week or holiday for the schedule to begin, the keypad displays any currently programmed Begin and End times previously set for that day. This feature allows you to review programmed schedules at any time.

3. If Begin and End times already exist, the keypad then displays DELETE KEEP. Select DELETE to enter new times.
4. The keypad then displays BEGIN TIME? followed by the display MON - : AM PM. Enter the new opening time and select AM or PM.

Enter all schedule times using a 12 hour clock. For example, to enter 6 AM you would enter a 0 + 6 + 0 + 0 and select AM. For 11 PM you would enter a 1 + 1 + 0 + 0 and select PM.

The keypad then displays END TIME? followed by the display MON - : AM PM. Enter the new closing time and select AM or PM. Select whichever day displays, for example, MON, allows you to scroll through the days of the week and create a schedule window that spans multiple days.

**Note:** You must enter a Begin and End time or the system will not recognize the schedule.

The new schedule is now programmed into your system.

5. The keypad goes back to the SUN MON TUE WED display. Press the Back Arrow key to enter another schedule.
6. To clear a schedule press DELETE and then AM when the opening time is requested.  
Press the Back Arrow key to exit the User Menu.

### Delete a Schedule

Select DEL to delete a schedule number.

1. Enter the Schedule number 01-99 that you want to delete.
2. The keypad displays DELETE SCHEDULE SURE? YES NO. Select YES to delete the schedule.
3. The keypad displays SCHEDULE NO: - DELETED and the keypad prompts you for the next schedule number to be deleted.

Press the Back Arrow key to exit the User Menu.

### Change a Schedule

Select CHG to edit an existing schedule.

1. Enter the schedule number 01-99 that you want to change.
2. The keypad displays ENTER SCHEDULE and the schedule name. To edit the name press any Select key to make changes. Press COMMAND to proceed.

3. The keypad displays SELECT WEEK DAY and SUN MON TUE WED. Press the COMMAND key to display THU FRI SAT HOL.
4. Enter the Begin and End times for each day of the schedule. Refer to Adding a Schedule for more information.
5. The keypad goes back to the SUN MON TUE WED display. Press the Back Arrow key to enter another schedule.  
Press the Back Arrow key to exit the User Menu.

## Setting Area, Output, and Door Schedules

The Schedules function allows you to assign up to 8 different schedule numbers to each area, output, and door access relay connected to your system. The schedule number allows the opening and closing times for the area and on/off times for outputs and door access relays

1. Access the User Menu.
2. Press COMMAND until SCHEDULES? displays.
3. After you have accessed the SCHEDULES? menu and the schedule options, TIMES AREAS DOOR, display, press the COMMAND key once more and the display changes to OUTPUT HOLIDAYS. Select AREAS, DOOR, or OUTPUT.
4. The keypad displays ENTER THE AREA/OUTPUT/DOOR NUMBER:- , enter the area, output, or door number you want to assign a schedule. Press the COMMAND key.
5. The keypad displays SCHEDULE NO: -. Press any Select key and enter the schedule number (01 to 99). Press the COMMAND key.
6. The keypad displays the next schedule number allowing you to enter additional programming. To exit the user menu press the Back Arrow key.

## Setting Holiday ABC Schedules

Three Holiday Schedules are available. This allows an output, area, or door to have three different schedules for holidays. For example, Holiday Schedule A for those holidays when the building stays closed, Holiday Schedule B for a day that only opens for a morning, etc. Also, Holiday Schedules can be used to cross multiple days. These schedules become active and supersede the current day's schedule when a Holiday Date occurs. See Setting Holiday Dates (HOL).

1. After you have accessed the SCHEDULES? menu and the schedule options, TIMES AREAS DOOR, display, press the COMMAND key until the display changes to OUTPUT HOLIDAYS. Press COMMAND once more and the display changes to FAVORITES.
2. Select HOLIDAY to program holiday schedules.
3. The keypad displays HOL: A B C . Select A to set the first of three holiday schedules.
4. The keypad displays A - : AM PM.

**Note:** After Selecting the schedule, the keypad displays any current times previously set for that holiday. This feature allows you to review the programmed times.

5. If times display, the keypad then displays DELETE KEEP. Select DELETE to enter new times.
6. The keypad then displays BEGIN TIME? This is followed by the display - : AM PM.  
Enter a new time and select AM or PM.  
The display changes to END TIME? This is followed by the display - : AM PM.  
Enter a new time.

Enter all schedule times using a 12 hour clock. For example, to enter 6 AM you would enter 0 + 6 + 0 + 0 select AM. For 11 PM you would enter 1 + 1 + 0 + 0 and select PM.

7. The keypad returns to HOL: A B C allowing you to enter A B and/or C holiday schedule for the same Output or Door. Go back to step 3 to add additional holiday schedules.

## Setting Holiday Dates (HOL)

Setting Holiday Dates provides the system with dates in the year when the normal opening and closing schedules are not used and superseded by one of the Holiday Schedules A or B or C. When the panel determines that it is a holiday, the Holiday Schedule supersedes the current schedule for that day. Up to forty different holiday dates can be entered.

1. After you access the SCHEDULES? menu and the schedule options, TIMES AREAS DOOR, display, press the COMMAND key once more. The display changes to OUTPUT HOLIDAY FAVORITES. Select Holiday to program Holiday dates.
2. The keypad display changes to HOL: xx mm/dd A. You can now enter the month and day for the first holiday. Select A to change to HOL B. Pressing again changes to HOL C. Example: July fourth would be entered by pressing the 0704 keys. The keypad displays HOL:1 07/04 B.
3. To step to the next holiday number, press COMMAND. To clear a holiday press any top row Select key when the appropriate holiday number displays. Press the Back Arrow key when HOL: 1 or the COMMAND key when HOL: 40 displays to exit the menu.

**Note:** The Holiday Dates entered indicate the days of the year when HOL schedules are used. For information on setting holiday schedules for Area, Output, and Door, see Setting Holiday ABC Schedules.

## Favorites

### Setting Favorites Schedules

Allows you to assign a Z-Wave Favorite to your programmed schedule.

1. Access the User Menu.
2. Press COMMAND until SCHEDULES displays. COMMAND through the options until FAVORITES displays. Press any Select key.
2. TIME AREAS DOOR displays. press COMMAND to display OUTPUTS HOLIDAYS. Press COMMAND to again to display FAVORITES.
4. Press the first Select key to input a Favorite number or press the last Select key to select from the list.

### Activate Favorites

Allows you to activate a certain Z-Wave Favorite per your programmed schedule.

1. Access the User Menu.
2. Press COMMAND until SCHEDULES displays. Press any Select key.
2. Choose the Favorite to activate (1-20) and press COMMAND to activate.
4. If the Favorite activation is successful, the keypad displays FAVORITE XX ACTIVATED (XX = Favorite number entered). If the Favorite activation is unsuccessful, the keypad displays FAVORITE XX NOT PROGRAMMED.

## Setting the Date and Time

Allows you to change the current date and time displayed on the keypad and used by the system.

### Setting the System's Date and Time

1. Access the User Menu.
2. Press COMMAND until TIME? displays. Press any Select key.
3. The keypad displays the current day and time. Press the COMMAND key. The keypad displays the current date. Press the COMMAND key to make any changes.
4. The keypad displays TIME DAY DATE.
5. Select TIME to change the time. The keypad displays - : AM PM. Enter the current time and select AM or PM. The display changes back to TIME DAY DATE.
6. Select DAY to change the day of week. The keypad displays SUN MON TUE WED. Press the COMMAND key to display THU FRI SAT. Select the correct day. Use the Back Arrow key to toggle between the different day of the week displays.
7. Select DATE to change the date. The keypad displays:  
**MONTH:-** Enter up to 2 digits for the month.  
Press COMMAND.  
**DAY:-** Enter up to 2 digits for the day.  
Press COMMAND.  
**YEAR:-** Enter up to 2 digits for the year.  
Press COMMAND.

The display returns to the TIME DAY DATE display.

Press the Back Arrow key to exit the User Menu.

## Display Events

Allows you to review up to 12,000 past door access and system events. There are six event types:

**Zone Activity** - Zone alarms, troubles, and restorals.

**Opening and Closing** - System arming and disarming.

**User Code** - Adding, deleting, and changing user codes.

**Schedule Changes** - Adding, deleting, and changing schedules.

**Door Access** - Each door access function used at a keypad.

**Supervisory** - Problems with system hardware components.

The system memory holds a maximum of 12,000 past events for 45 days. Any event older than 45 days automatically clears from the system memory. Also, once the full 12,000 events are stored, any new event causes the oldest event to be cleared. See Appendix A for Display Events.

## Service Request

Your user code profile may be programmed for Service Request. This User Menu feature allows you to simply press any Select key when SERVICE REQUEST? displays and have the system automatically send a "Request for Service" message to the central station. The display changes momentarily to REQUEST MADE to confirm your request was sent.

## **Fire Drill**

Fire Drill is used to test the fire bells or fire horns in your system. The Fire Drill test turns your system bell circuit on, but does not send a message to the central station.

### **Starting a Fire Drill test**

1. Access the User Menu.
2. Press COMMAND until FIRE DRILL? displays. Press any Select key.
3. The keypad displays SURE? YES NO.
4. Select YES to start the Fire Drill test.

### **Ending a Fire Drill test**

1. Enter your code at the keypad and press COMMAND to end the Fire Drill.
2. The Fire Drill test automatically ends with ALARM SILENCE or the programmed Bell Cutoff time.

# System Setup

## System Setup Record

This System Setup section allows you to track the current and future status of the programmable options on your system. If changes are made to the system, update the information contained on these pages.

- XR150 System       XR350 System  
 XR550 System

Your system operation configuration.

- Area       Home/Sleep/Away  
 All/Perimeter    Home/Sleep/Away with Guest

Your system is monitored by a central station.

- Yes    No

C/S Name: \_\_\_\_\_

Address: \_\_\_\_\_

City/State: \_\_\_\_\_

Emergency Phone: \_\_\_\_\_

Service Phone: \_\_\_\_\_

Service Manager: \_\_\_\_\_

Your system sends Opening and Closing reports.

- Yes    No

Your system sends Zone Bypass reports.

- Yes    No

Your system sends Ambush reports.

- Yes    No

Your XR550E system uses Card Plus PIN operation.

- Yes    No

## Keypad Record

Note: XR150 systems support 8 keypad devices. XR350 and XR550 systems support 16 keypad devices.

| <u>Device #</u> | <u>Name</u> | <u>Areas</u> |
|-----------------|-------------|--------------|
| 1_____          | _____       | _____        |
| 2_____          | _____       | _____        |
| 3_____          | _____       | _____        |
| 4_____          | _____       | _____        |
| 5_____          | _____       | _____        |
| 6_____          | _____       | _____        |
| 7_____          | _____       | _____        |
| 8_____          | _____       | _____        |
| 9_____          | _____       | _____        |
| 10_____         | _____       | _____        |
| 11_____         | _____       | _____        |
| 12_____         | _____       | _____        |
| 13_____         | _____       | _____        |
| 14_____         | _____       | _____        |
| 15_____         | _____       | _____        |
| 16_____         | _____       | _____        |

### Which keypads display System Status?

- 1     2     3     4  
 5     6     7     8  
 9     10     11     12  
 13     14     15     16     N/A

### Which keypads display Armed Status?

- 1     2     3     4  
 5     6     7     8  
 9     10     11     12  
 13     14     15     16     N/A

### Which keypads provide Door Access reports?

- 1     2     3     4  
 5     6     7     8  
 9     10     11     12  
 13     14     15     16     N/A

## Key Fob Button Programming

Enter the user name assigned to each key fob and the button action programmed for each button in the table below. Refer to the Introduction and Appendix D for more information.

| Key Fob User Name | Button | Programmed Action |
|-------------------|--------|-------------------|
|                   | TOP    |                   |
|                   | BTM    |                   |
|                   | LFT    |                   |
|                   | RGT    |                   |
|                   | TOP    |                   |
|                   | BTM    |                   |
|                   | LFT    |                   |
|                   | RGT    |                   |
|                   | TOP    |                   |
|                   | BTM    |                   |
|                   | LFT    |                   |
|                   | RGT    |                   |
|                   | TOP    |                   |
|                   | BTM    |                   |
|                   | LFT    |                   |
|                   | RGT    |                   |
|                   | TOP    |                   |
|                   | BTM    |                   |
|                   | LFT    |                   |
|                   | RGT    |                   |



## Area Names and Numbers Record

XR150 systems may be divided into 8 separate areas while XR350 systems may be divided into 16 separate areas. XR550 systems may be divided into 32 separate areas. All/Perimeter systems are divided into two separate areas. Home/Sleep/Away and Home/Sleep/Away with Guest systems are divided into two or three separate areas. Each area can have a name or description that displays at the keypad. This can help you easily track events when and wherever they occur in your system.

### Area Name

|    |       |
|----|-------|
| 1  | _____ |
| 2  | _____ |
| 3  | _____ |
| 4  | _____ |
| 5  | _____ |
| 6  | _____ |
| 7  | _____ |
| 8  | _____ |
| 9  | _____ |
| 10 | _____ |
| 11 | _____ |
| 12 | _____ |
| 13 | _____ |
| 14 | _____ |
| 15 | _____ |
| 16 | _____ |

### AreaName

|    |       |
|----|-------|
| 17 | _____ |
| 18 | _____ |
| 19 | _____ |
| 20 | _____ |
| 21 | _____ |
| 22 | _____ |
| 23 | _____ |
| 24 | _____ |
| 25 | _____ |
| 26 | _____ |
| 27 | _____ |
| 28 | _____ |
| 29 | _____ |
| 30 | _____ |
| 31 | _____ |
| 32 | _____ |

## Z-Wave Device Name

|    |       |    |       |
|----|-------|----|-------|
| 1  | _____ | 21 | _____ |
| 2  | _____ | 22 | _____ |
| 3  | _____ | 23 | _____ |
| 4  | _____ | 24 | _____ |
| 5  | _____ | 25 | _____ |
| 6  | _____ | 26 | _____ |
| 7  | _____ | 27 | _____ |
| 8  | _____ | 28 | _____ |
| 9  | _____ | 29 | _____ |
| 10 | _____ | 30 | _____ |
| 11 | _____ | 31 | _____ |
| 12 | _____ | 32 | _____ |
| 13 | _____ | 33 | _____ |
| 14 | _____ | 34 | _____ |
| 15 | _____ | 35 | _____ |
| 16 | _____ | 36 | _____ |
| 17 | _____ | 37 | _____ |
| 18 | _____ | 38 | _____ |
| 19 | _____ | 39 | _____ |
| 20 | _____ | 40 | _____ |

## Z-Wave Favorites List

Your system has Favorites that can be used for various functions. The list below identifies the Favorite number, name, and devices.

| Favorite # | Favorite Name | Devices included |
|------------|---------------|------------------|
| <hr/>      | <hr/>         | <hr/>            |
| <hr/>      | <hr/>         | <hr/>            |
| <hr/>      | <hr/>         | <hr/>            |
| <hr/>      | <hr/>         | <hr/>            |
| <hr/>      | <hr/>         | <hr/>            |
| <hr/>      | <hr/>         | <hr/>            |
| <hr/>      | <hr/>         | <hr/>            |
| <hr/>      | <hr/>         | <hr/>            |
| <hr/>      | <hr/>         | <hr/>            |
| <hr/>      | <hr/>         | <hr/>            |
| <hr/>      | <hr/>         | <hr/>            |
| <hr/>      | <hr/>         | <hr/>            |
| <hr/>      | <hr/>         | <hr/>            |
| <hr/>      | <hr/>         | <hr/>            |
| <hr/>      | <hr/>         | <hr/>            |
| <hr/>      | <hr/>         | <hr/>            |
| <hr/>      | <hr/>         | <hr/>            |
| <hr/>      | <hr/>         | <hr/>            |
| <hr/>      | <hr/>         | <hr/>            |
| <hr/>      | <hr/>         | <hr/>            |
| <hr/>      | <hr/>         | <hr/>            |



## User Codes Record

As you add new users or change current user codes, you can keep track of their profile number in the system. Use the following table to track custom user codes in your system. Only 4-digit user codes can be assigned to All/Perimeter, Home/Sleep/Away, or Home/Sleep/Away with Guest system users.

| User # | User Name | Profile # |
|--------|-----------|-----------|
|        |           |           |
|        |           |           |
|        |           |           |
|        |           |           |
|        |           |           |
|        |           |           |
|        |           |           |
|        |           |           |
|        |           |           |
|        |           |           |
|        |           |           |
|        |           |           |
|        |           |           |
|        |           |           |
|        |           |           |
|        |           |           |
|        |           |           |
|        |           |           |
|        |           |           |
|        |           |           |
|        |           |           |
|        |           |           |
|        |           |           |

| User # | User Name | Profile # |
|--------|-----------|-----------|
|        |           |           |
|        |           |           |
|        |           |           |
|        |           |           |
|        |           |           |
|        |           |           |
|        |           |           |
|        |           |           |
|        |           |           |
|        |           |           |
|        |           |           |
|        |           |           |
|        |           |           |
|        |           |           |
|        |           |           |
|        |           |           |
|        |           |           |
|        |           |           |
|        |           |           |
|        |           |           |
|        |           |           |
|        |           |           |
|        |           |           |
|        |           |           |

## Schedules Record

| Schedule # | Schedule Name | Status       | SUN          | MON          | TUE          | WED          | THU          | FRI          | SAT          | HOL A        | HOL B        | HOL C        |
|------------|---------------|--------------|--------------|--------------|--------------|--------------|--------------|--------------|--------------|--------------|--------------|--------------|
|            |               | Begin<br>End | : _M<br>: _M | : _M<br>: _M | : _M<br>: _M | : _M<br>: _M | : _M<br>: _M | : _M<br>: _M | : _M<br>: _M | : _M<br>: _M | : _M<br>: _M | : _M<br>: _M |
|            |               | Begin<br>End | : _M<br>: _M | : _M<br>: _M | : _M<br>: _M | : _M<br>: _M | : _M<br>: _M | : _M<br>: _M | : _M<br>: _M | : _M<br>: _M | : _M<br>: _M | : _M<br>: _M |
|            |               | Begin<br>End | : _M<br>: _M | : _M<br>: _M | : _M<br>: _M | : _M<br>: _M | : _M<br>: _M | : _M<br>: _M | : _M<br>: _M | : _M<br>: _M | : _M<br>: _M | : _M<br>: _M |
|            |               | Begin<br>End | : _M<br>: _M | : _M<br>: _M | : _M<br>: _M | : _M<br>: _M | : _M<br>: _M | : _M<br>: _M | : _M<br>: _M | : _M<br>: _M | : _M<br>: _M | : _M<br>: _M |
|            |               | Begin<br>End | : _M<br>: _M | : _M<br>: _M | : _M<br>: _M | : _M<br>: _M | : _M<br>: _M | : _M<br>: _M | : _M<br>: _M | : _M<br>: _M | : _M<br>: _M | : _M<br>: _M |
|            |               | Begin<br>End | : _M<br>: _M | : _M<br>: _M | : _M<br>: _M | : _M<br>: _M | : _M<br>: _M | : _M<br>: _M | : _M<br>: _M | : _M<br>: _M | : _M<br>: _M | : _M<br>: _M |
|            |               | Begin<br>End | : _M<br>: _M | : _M<br>: _M | : _M<br>: _M | : _M<br>: _M | : _M<br>: _M | : _M<br>: _M | : _M<br>: _M | : _M<br>: _M | : _M<br>: _M | : _M<br>: _M |
|            |               | Begin<br>End | : _M<br>: _M | : _M<br>: _M | : _M<br>: _M | : _M<br>: _M | : _M<br>: _M | : _M<br>: _M | : _M<br>: _M | : _M<br>: _M | : _M<br>: _M | : _M<br>: _M |
|            |               | Begin<br>End | : _M<br>: _M | : _M<br>: _M | : _M<br>: _M | : _M<br>: _M | : _M<br>: _M | : _M<br>: _M | : _M<br>: _M | : _M<br>: _M | : _M<br>: _M | : _M<br>: _M |
|            |               | Begin<br>End | : _M<br>: _M | : _M<br>: _M | : _M<br>: _M | : _M<br>: _M | : _M<br>: _M | : _M<br>: _M | : _M<br>: _M | : _M<br>: _M | : _M<br>: _M | : _M<br>: _M |
|            |               | Begin<br>End | : _M<br>: _M | : _M<br>: _M | : _M<br>: _M | : _M<br>: _M | : _M<br>: _M | : _M<br>: _M | : _M<br>: _M | : _M<br>: _M | : _M<br>: _M | : _M<br>: _M |
|            |               | Begin<br>End | : _M<br>: _M | : _M<br>: _M | : _M<br>: _M | : _M<br>: _M | : _M<br>: _M | : _M<br>: _M | : _M<br>: _M | : _M<br>: _M | : _M<br>: _M | : _M<br>: _M |

## Holiday Date Record

Your system has up to 40 holiday dates available that supersede all regular scheduled times for that day.

# Date (mm/dd) HOL (circle one)

1. \_\_\_\_/\_\_\_\_ A or B or C
2. \_\_\_\_/\_\_\_\_ A or B or C
3. \_\_\_\_/\_\_\_\_ A or B or C
4. \_\_\_\_/\_\_\_\_ A or B or C
5. \_\_\_\_/\_\_\_\_ A or B or C
6. \_\_\_\_/\_\_\_\_ A or B or C
7. \_\_\_\_/\_\_\_\_ A or B or C
8. \_\_\_\_/\_\_\_\_ A or B or C
9. \_\_\_\_/\_\_\_\_ A or B or C
10. \_\_\_\_/\_\_\_\_ A or B or C
11. \_\_\_\_/\_\_\_\_ A or B or C
12. \_\_\_\_/\_\_\_\_ A or B or C
13. \_\_\_\_/\_\_\_\_ A or B or C
14. \_\_\_\_/\_\_\_\_ A or B or C
15. \_\_\_\_/\_\_\_\_ A or B or C
16. \_\_\_\_/\_\_\_\_ A or B or C
17. \_\_\_\_/\_\_\_\_ A or B or C
18. \_\_\_\_/\_\_\_\_ A or B or C
19. \_\_\_\_/\_\_\_\_ A or B or C
20. \_\_\_\_/\_\_\_\_ A or B or C

# Date (mm/dd) HOL (circle one)

21. \_\_\_\_/\_\_\_\_ A or B or C
22. \_\_\_\_/\_\_\_\_ A or B or C
23. \_\_\_\_/\_\_\_\_ A or B or C
24. \_\_\_\_/\_\_\_\_ A or B or C
25. \_\_\_\_/\_\_\_\_ A or B or C
26. \_\_\_\_/\_\_\_\_ A or B or C
27. \_\_\_\_/\_\_\_\_ A or B or C
28. \_\_\_\_/\_\_\_\_ A or B or C
29. \_\_\_\_/\_\_\_\_ A or B or C
30. \_\_\_\_/\_\_\_\_ A or B or C
31. \_\_\_\_/\_\_\_\_ A or B or C
32. \_\_\_\_/\_\_\_\_ A or B or C
33. \_\_\_\_/\_\_\_\_ A or B or C
34. \_\_\_\_/\_\_\_\_ A or B or C
35. \_\_\_\_/\_\_\_\_ A or B or C
36. \_\_\_\_/\_\_\_\_ A or B or C
37. \_\_\_\_/\_\_\_\_ A or B or C
38. \_\_\_\_/\_\_\_\_ A or B or C
39. \_\_\_\_/\_\_\_\_ A or B or C
40. \_\_\_\_/\_\_\_\_ A or B or C

## Output Record

Your system has outputs that are used to control various functions within the building or access around its perimeter. The list below identifies the output numbers and device names.

| Output # | Output Name |
|----------|-------------|
| _____    | _____       |
| _____    | _____       |
| _____    | _____       |
| _____    | _____       |
| _____    | _____       |
| _____    | _____       |
| _____    | _____       |
| _____    | _____       |
| _____    | _____       |
| _____    | _____       |
| _____    | _____       |
| _____    | _____       |
| _____    | _____       |
| _____    | _____       |
| _____    | _____       |
| _____    | _____       |
| _____    | _____       |
| _____    | _____       |
| _____    | _____       |
| _____    | _____       |
| _____    | _____       |
| _____    | _____       |

Use the Output number in the User Menu when setting Output Schedules or using the Outputs ON OFF option to manually toggle the relays.

## About the Display Events Section

This section of the User's Guide shows the Display Events items. While in the Display Events function, use the COMMAND and Back Arrow keys to go forward or backward through the list of events.

To view more information about each display, press the Select key as directed in the explanations below.

## Using the Display Events

1. Access the User Menu.
2. Press the COMMAND key until DISPLAY EVENTS? displays. Press any Select key.
3. The keypad displays FRST LST PRT SRT. Select FRST (first) to view the oldest to newest events. Select LST (last) to view the newest to oldest events. If you select FIRST, use the COMMAND key to scroll up through the events. If you select LAST, use the Back Arrow key to scroll down through the events.

Select SRT to sort through the Display Events log and collect information specific to a user or system event.

Select PRT to print the complete Display Events log.

4. To use the Sort feature, select SRT. The keypad displays FRST DATE: 8/21. Press any Select key and enter a 4-digit beginning date for the sort. Press COMMAND.
5. The keypad displays LAST DATE: 10/17. Press any Select key and enter a 4-digit ending date for the sort. Press COMMAND.

6. The keypad displays USER NUMBER: -. To sort events for a particular user, enter their user number or press COMMAND to sort for all users. To search for a user, press any Select key then use the COMMAND and Back Arrow keys to browse through the user names in the system. When the user you want displays, press any Select key then press COMMAND.

7. The keypad next displays five event types that you can include in the sort. Press the fourth Select key to display YES when the event type name displays on the keypad. Press COMMAND. The following are the sort event types:

**ACCESSES** = door accesses granted.

**DOOR NUMBER** = leave blank for all doors.

- Note:** If you select yes for access then only Door Access Granted Events are included in the sort.

**ZONE EVENTS** = zone alarms, troubles, and restorals.

**ARM/DISARM** = arming and disarming events.

**USER EVENTS** = adding, deleting, and changing user codes.

**SUPERVISORY** = system hardware problems and door access denied events.

8. After the last event type displays, the keypad again displays FRST LST PRT SRT. You can now view or print the sorted Display Events or press SRT to define a new sort.



## Appendix A

### Arming and Disarming Event Displays

This displays any system area arming or disarming events.

#### Keypad Display

```
ARM   5:10P   10/17
WAREHOUSE
```

#### Description

The Warehouse was armed on October 17 at 5:10 PM. Press any Select key to display the area number and user number, and then any Select key to display the user name.

Arming Event Types - There are two event types you may see:

**ARM** - User armed the system    **DIS** - User disarmed the system

### Zone Event Displays

This displays alarms, troubles, and other events that may occur on your protection zones.

#### Keypad Display

```
ALR   10:23P   10/17
BASEMENT DOOR
```

#### Description

An alarm occurred on October 17 at 10:23 PM. Press any Select key to see the zone number and zone type.

Zone Type - There are seven possible zone types you may see:

**FIRE** - Fire                    **PANC** - Panic    **BURG** - Burglary  
**EMRG** - Emergency            **SUPV** - Supervisory  
**AUX1** - Auxiliary 1            **AUX2** - Auxiliary 2

Event Types - There are seven event type you may see:

**ALR** - Alarm            **TBL** - Trouble            **RST** - Restore  
**FLT** - Zone Fault            **SVC** - Service smoke detector  
**LOW** - Low battery            **MIS** - Missing wireless transmitter

**Note:** LOW and MIS are for wireless systems only.

### Supervisory Event Displays

This displays the date and time of an automatic test report.

#### Keypad Display

```
MSG   11:58P   10/17
AUTO RECALL
```

#### Description

The test report was sent to the central station at the date and time shown.

### User Code Change Event Displays

This displays any addition, deletion, or change to a user code.

#### Keypad Display

```
ADD   11:41A   10/17
U:19   BY      U:12
```

#### Description

User 19 added at 11:41 AM by user 12. Select either user (US:) number for the user name.

User Code Event Types - There are three event type you may see:

**ADD** - User added                    **DEL** - User deleted  
**CHG** - User code or authority level changed.

### Zone Bypass Event Displays

This displays zone bypass events.

#### Keypad Display

```
BYP   5:18P   10/17
EAST WINDOW
```

#### Description

The east window zone was bypassed. Press any Select key for the zone number and user number. Press again for the user name.

Bypass Event Types - There are three event types:

**BYP** - Bypass            **RST** - Restore            **FRC** - Force Arm

**Note:** You may sometimes see the user as SWG. This is short for Swinger Bypass which is an automatic function that allows the system to automatically bypass a zone.

## Door Access Event Displays

This displays the keypad address where a Door Access occurred and the user number of the person granted access.

### Keypad Display

|     |          |       |
|-----|----------|-------|
| ACC | 5:18P    | 10/17 |
| 3   | USER:024 |       |

### Description

User 24 accessed door (keypad) #3 at 5:18 PM on October 17. Press the first Select key to display the Door name where the access occurred. Press the second Select key to display the reason access was denied. Press the third Select key for the name of the device, or the fourth Select key for the user name.

## About Door Access

Door Access is a feature available on certain keypads that contain a built-in door releasing relay and proximity readers. When power for an electric door strike or magnetic lock is connected to the relay contacts, only users entering a valid user code can release the lock and gain access to the area.

The Display Events feature logs the user number and name of the person granted access, the date and time, and from which keypad they entered their code.

## System Monitor Event Displays

This displays any problems with the system AC power, battery, or phone line(s), or any opening of a tampered panel box.

### Keypad Display

|       |        |       |
|-------|--------|-------|
| TBL   | 11:41A | 10/17 |
| POWER |        |       |

### Description

An AC failure occurred on October 17 at 11:41 AM.

System Monitor Event Types - There are two event types:

**TBL** - Trouble                      **RST** - Restore

System Monitor Event Names - There are five system monitors:

**POWER** - AC power to panel      **BATTERY** - On panel

**LINE 1** - Phone line number 1      **LINE 2** - Phone line number 2

**TAMPER** - On panel box

## Schedule Change Event Displays

This displays Changes made to the system schedules.

### Keypad Display

|     |          |       |
|-----|----------|-------|
| S1  | 9:41A    | 10/17 |
| MON | USER:024 |       |

### Description

S1 schedule for Monday was changed by user 24 at 9:41 AM on October 17.

Schedule Types - There are five possible schedule types:

**S1 S2 S3 S4** - Standard                      **OUT** - Output

**DOOR** - Door                      **HOL** - Holiday                      **EXT** - Extend

**MON** - This is the day of the week in which the schedule change occurred. The days display using three letters. Press the first Select key to display the scheduled Opening time and once again for the scheduled Closing time.

024 - User number of the person who made the change. Press the third Select key under 024 to display the user name.

## Wireless Jamming Event Displays

This displays wireless jamming events that have occurred.

### Keypad Display

|                              |
|------------------------------|
| ALM 11:41A 10/17<br>WIRELESS |
|------------------------------|

### Description

The DMP wireless receiver detected jamming on October 17 at 11:41 AM.

Wireless Jamming Event Types - There are three event types:

**TBL** - Trouble (a jamming event occurred when the panel was disarmed)

**ALM** - Alarm (a jamming event occurred when any area was armed)

**RST** - Restore

**Note:** Trouble and Restore events display WIRELESS as the device.

## Wireless Trouble Event Displays

This displays events when the wireless receiver was not communicating with the panel.

### Keypad Display

|                              |
|------------------------------|
| TBL 11:41A 10/17<br>WIRELESS |
|------------------------------|

### Description

A DMP wireless device trouble occurred on October 17 at 11:41 AM.

Wireless Trouble Event Types - There are two event types:

**TBL** - Trouble

**RST** - Restore

**Note:** Trouble and Restore events display WIRELESS as the device.

# Appendix B

## Zone Status Browser

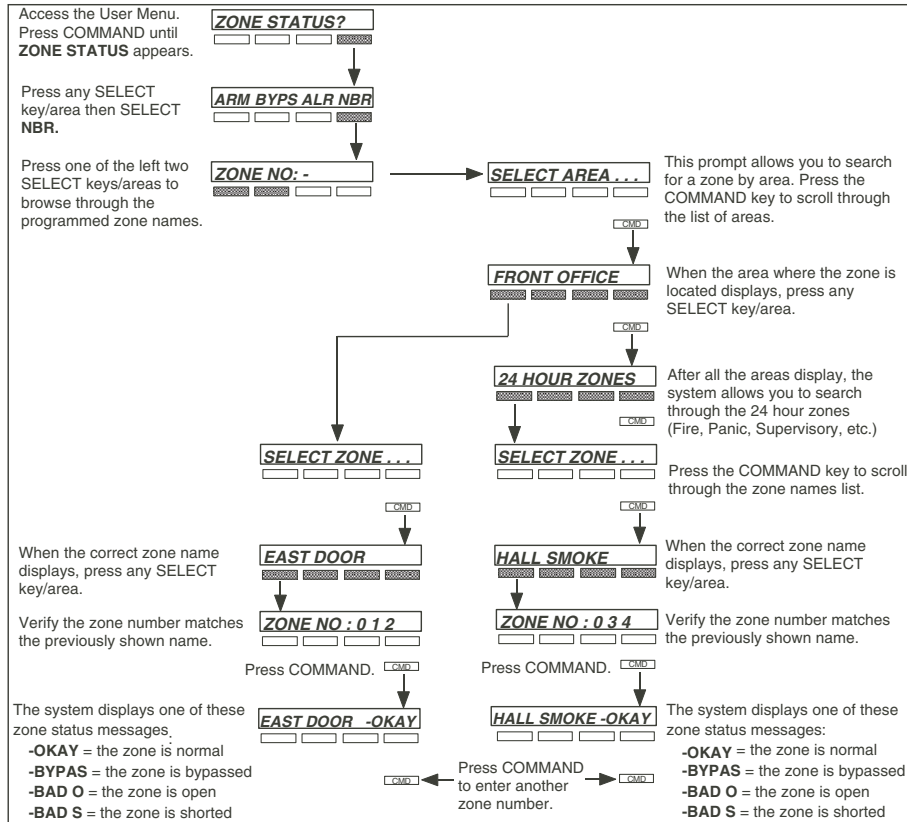

## Bypass Zones Browser

Access the User Menu.  
Press COMMAND to display **BYPASS ZONES**.  
Press any SELECT key/area.

**BYPASS ZONES?**

Press either of the two left SELECT keys/areas.

**ZONE: - RST BYP**

This prompt allows you to search for a zone by area.  
Press the COMMAND key to scroll through the list of areas.

**SELECT AREA ...**

When the area where the zone is located displays, press any SELECT key/area.

**FRONT OFFICE**

CMD

**SELECT ZONE ...**

Press the COMMAND key to scroll through the zone names list.

**EAST DOOR**

CMD

**ZONE:012 RST BYP**

When the correct zone name displays, press any SELECT key/area.

The display shows the zone number. SELECT **RST** to Reset the zone. SELECT **BYP** to Bypass the zone.

**ZONE: - RST BYP**

The display returns to the **ZONE:** prompt allowing you to enter another zone number.

## Zone Monitor Browser

Access the User Menu. Press COMMAND until **ZONE MONITOR?** displays. Press any SELECT key/area.

**ZONE MONITOR?**

SELECT **NBR**.

**ALL NBR**

Press either of the two left SELECT keys/areas.

**ZONE: - ADD RMV**

This prompt allows you to search for a zone by area. Press the COMMAND key to scroll through the list of areas.

**SELECT AREA ...**

CMD

**FRONT OFFICE**

When the area where the zone is located displays, press any SELECT key/area.

**SELECT ZONE ...**

Press the COMMAND key to scroll through the zone names list.

CMD

**EAST DOOR**

When the correct zone name displays, press any SELECT key/area.

The display shows the zone number.

**ZONE:012 ADD RMV**

Selecting **ADD** places the zone in monitor mode.

Selecting **RMV** removes the zone from monitor mode.

## Add User Codes Browser

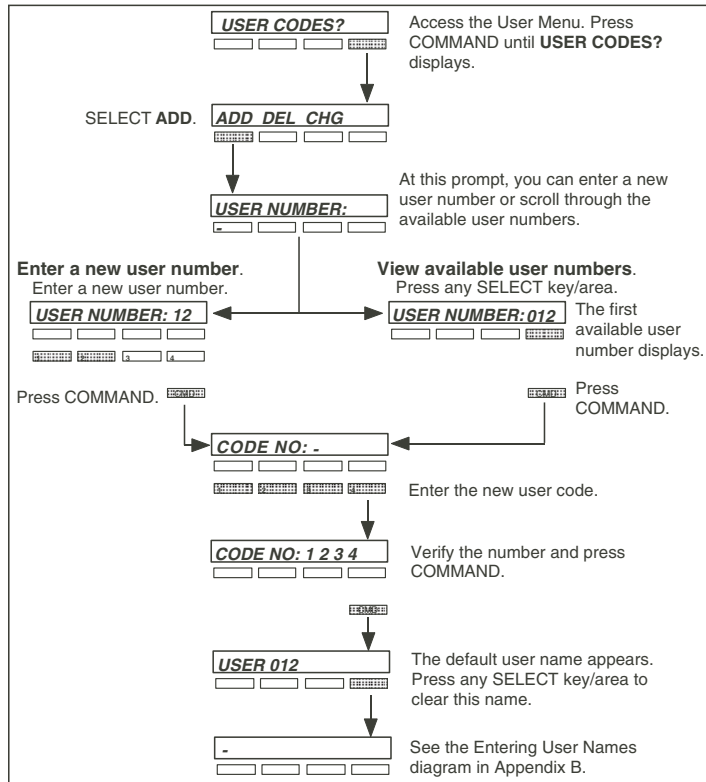

## Change User Codes Browser

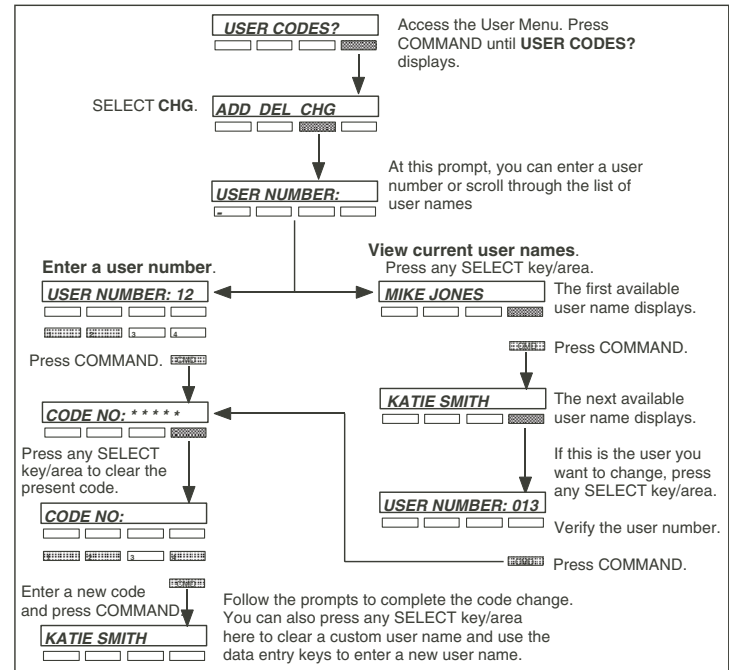

## Delete User Codes Browser

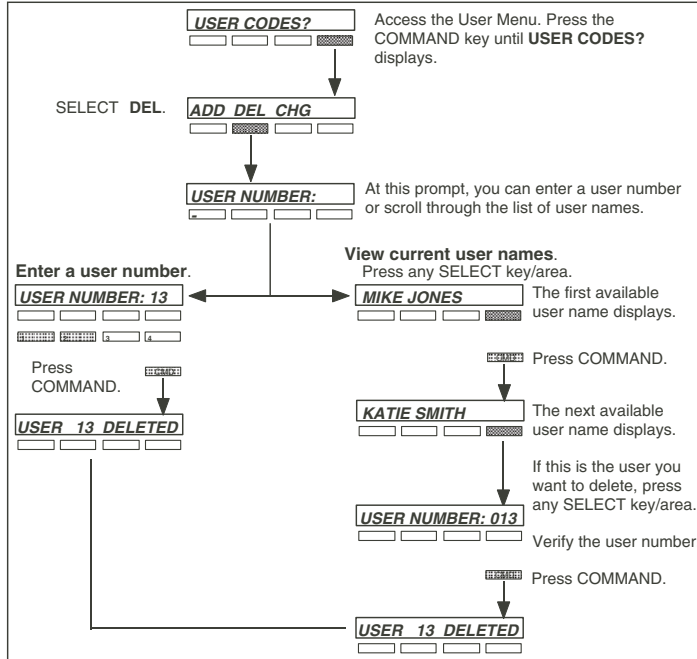

## Add User Profiles Browser

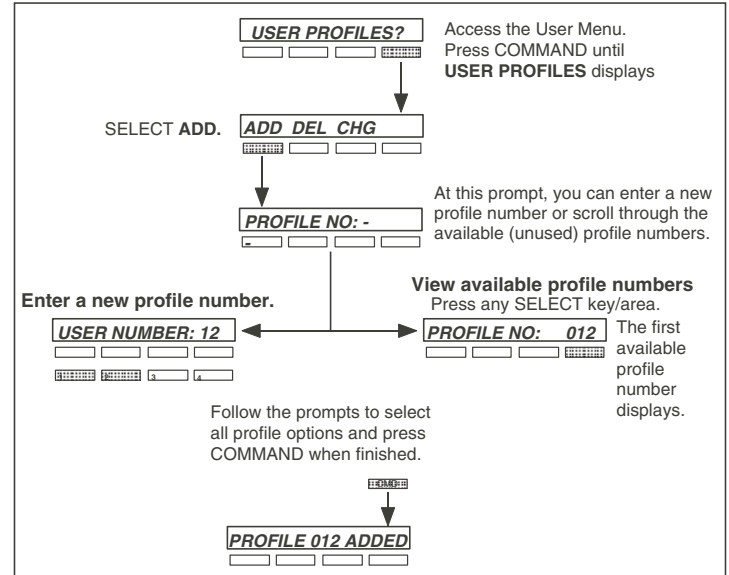

## Change User Profiles Browser

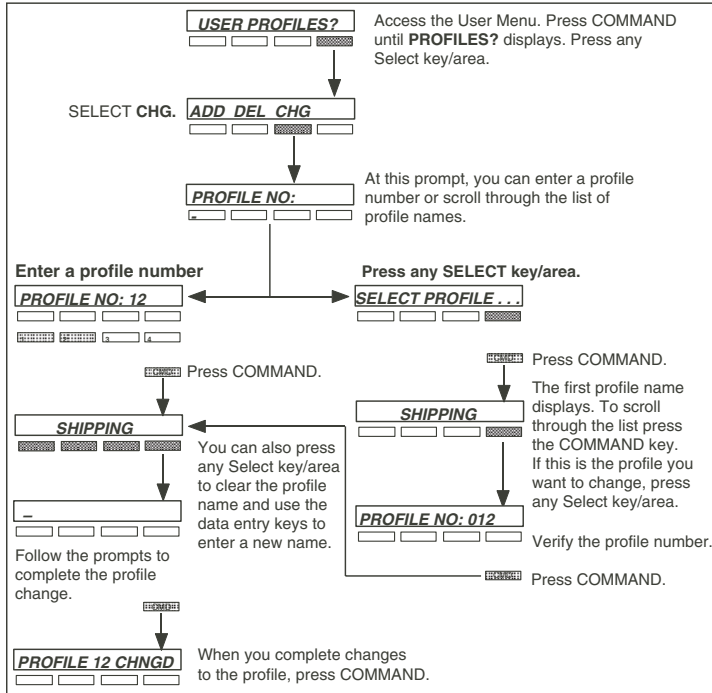

## Delete User Profiles Browser

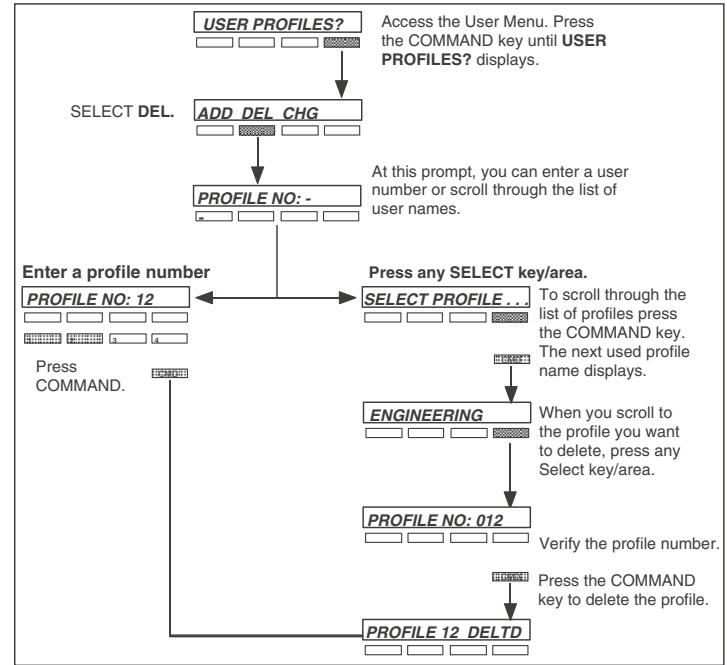



# Appendix C

## Output Groups Browser

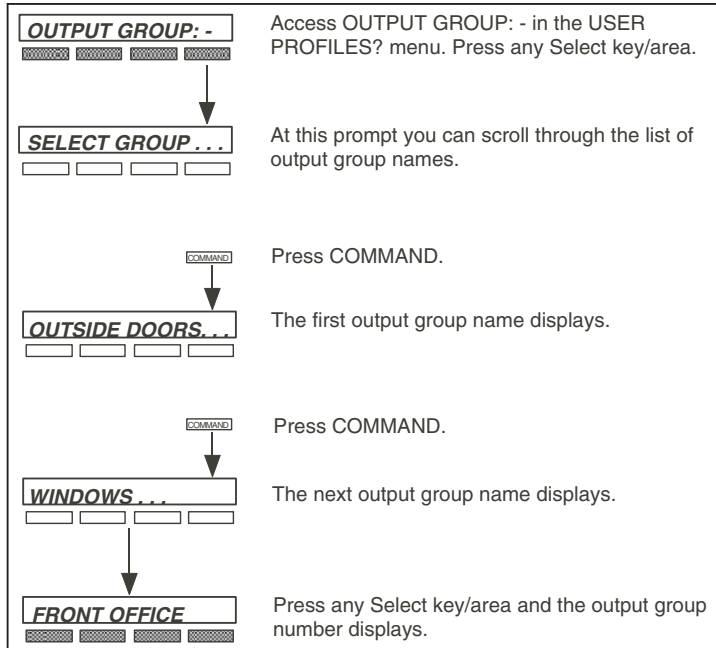

## Outputs On/Off Browser

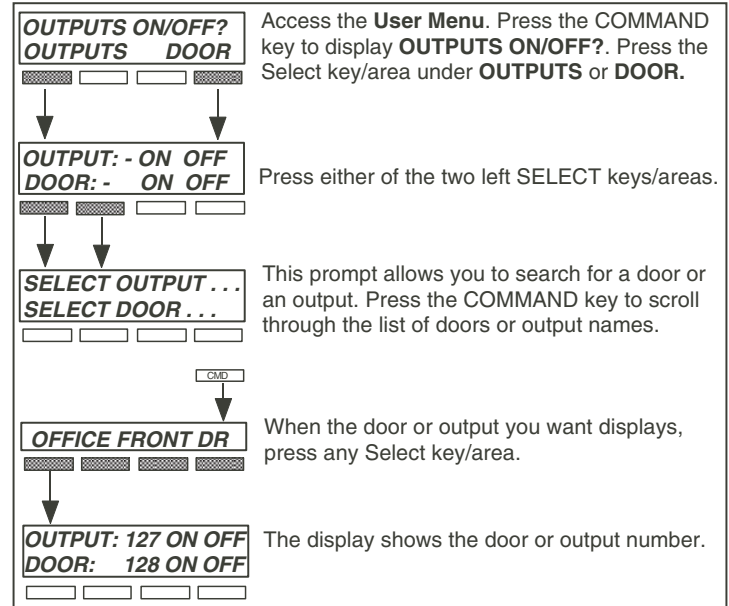

## User Disarm and Entry

Use the following steps to disarm your system and silence an alarm.

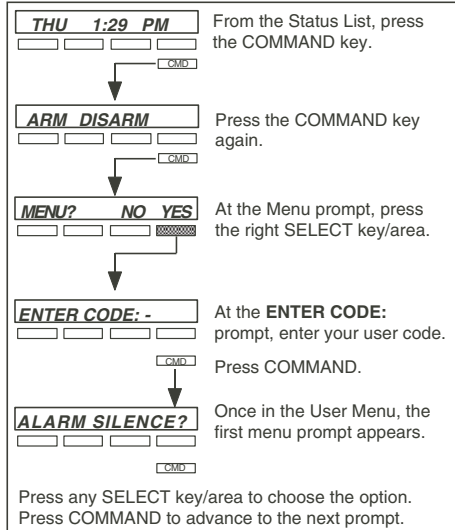

## Appendix D

### Entering User Names

Refer to the following when entering names information into the keypad.

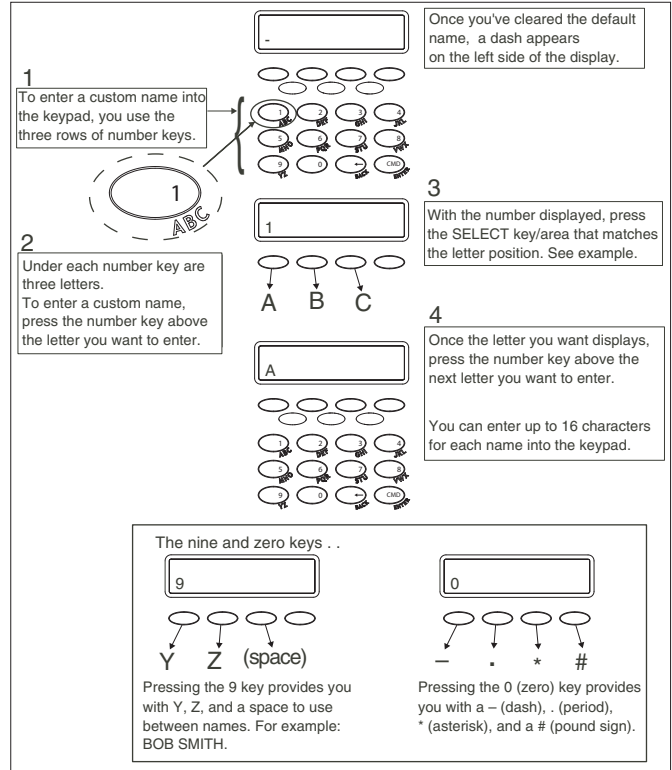

## Appendix E

### DMP Wireless Description

If your system uses DMP Wireless devices and includes key fob(s), refer to the following information. The DMP Wireless section includes a brief discussion of key fob(s) and a drawing identifying the key fob buttons. Refer to the System Setup section of this guide to check the button programming list for key fob(s) connected to your system.

For best operation, allow the LED to light and turn off before pressing another button. The key fob may not complete sending the signal for the button press if another button is pressed too soon.

### LED Status Operation

Depending on the programmed action of a key fob button, the Status LED lights to acknowledge a button press or to indicate the armed state of the system.

- When the button is programmed for Panic, Panic 2, Emergency, Emergency 2, Output, or Sensor Reset, a 1/2 second Green light displays to acknowledge the button press.
- When the button is programmed for Arm, Disarm, Toggle arm/disarm, or Status, the system armed status is received by the key fob and the LED lights once as shown in the table below.

| LED Color | Duration    | Description                     |
|-----------|-------------|---------------------------------|
| Red       | 2.0 Seconds | All System On                   |
| Green     | 2.0 Seconds | All System Off                  |
| Green/Red | 2.0 Seconds | System On<br>(Some Areas Armed) |

When a button programmed as Unused is pressed, the LED does not operate.

## Easy Entry™ User's Guide

### Door Strike

From the Status List, present your card to the reader. Once validated by the system, the Door Strike relay activates. If you are entering an armed area to which you are assigned, accessing the area automatically causes it to be disarmed.

While the keypad displays the Status List, present your access card. The relay activates momentarily during which you must open the door. Once you open the door, you have 30 seconds to exit and close the door before the zone 2 Soft-Shunt expires and triggers an alarm.

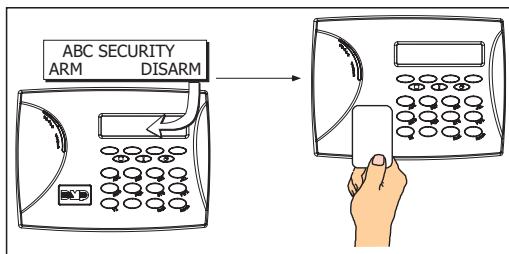

### Arming and Disarming an Area System

Press Command, the keypad displays **ARM** **DISARM**. Press the Select key under the desired option. The keypad displays **ENTER CODE-**. Present your card to the reader. Once validated by the system, all areas assigned to your code arm or disarm automatically. Select **NO** to arm or disarm individual areas. Select **YES**, or simply wait, and the keypad automatically arms or disarms all areas for which you are authorized.

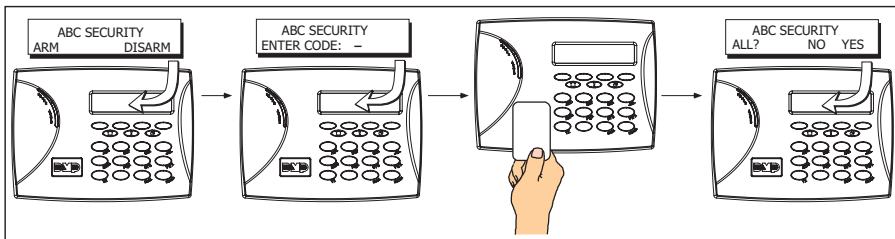

## Arming and Disarming an All/Perimeter System

Press **COMMAND**. The keypad displays **PERIM ALL** (when arming) or **DISARM?**. Press the Select key under the desired option. The keypad displays **ENTER CODE: -**.

Present your card to the reader. Once the system validates the card, if you choose **PERIM**, only the perimeter arms. If you choose **ALL**, both areas arm. If programmed on a 32-character keypad, **ALL** may be automatically chosen for you after a short delay. Present your card to the reader and all armed areas disarm automatically.

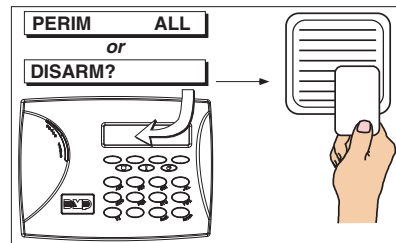

## Arming and Disarming a Home/Sleep/Away System and a Home/Sleep/Away with Guest System

Present your card to the reader. If the system is armed, once the system validates the card, all areas are disarmed and the keypad displays **ALL SYSTEM OFF**.

If the system is disarmed when you present your card, once the system validates the card, **HOME SLEEP AWAY** displays. You can manually press the Select key under the desired option or after short time all areas may be automatically armed in the **AWAY** mode.

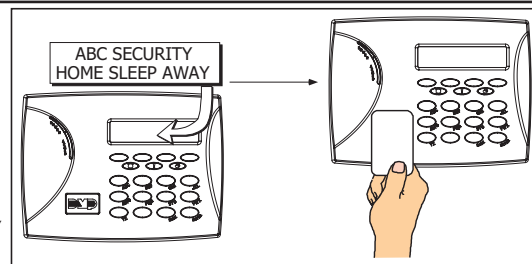

## Disarming with Entry Delay

**All Systems** - Once the protected door is opened and the entry delay starts, the keypad displays **ENTER CODE: -**. Present your card to the reader. Once validated, the system disarms all areas accessible by you. Area systems provide a delay to allow selected areas only to be disarmed. See Arming and Disarming above and on the previous page.

### Using the Access Reader for User Menu Access

You can also use a card reader to access the User Menu. When **MENU? NO YES** displays, select **YES** and enter a code when requested.

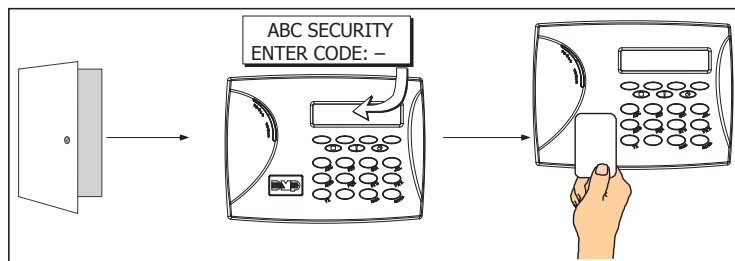

# Appendix F

## Email/Cell Phone Message User's Guide

Your security system's reporting capability can be used to send reports to an email address or cell phone number in much the same way as someone sending you an email would do. You can receive reports of alarms, troubles, or system arming and disarming and know at a glance your system status.

The following are types of messages that can be sent:

- \* Zone Alarms by Zone Name
- \* Zone Bypass by User
- \* Disarming (Openings) by User
- \* AC Power (and restoral)
- \* Ambush
- \* Alarm Verified by User
- \* Zone Troubles by Zone Name
- \* Armings (Closings) by User
- \* Late to Close
- \* System Low Battery
- \* Abort & Cancel by User
- \* System Test

For alarm messages, the message provides the system name, zone name, zone number, message type, and the time at which the panel sent the message.

For alarm messages sent to a cell phone number, you have the option to reply with "cancel" to cancel the existing alarm.

From: John's Home System (mailto: AlarmAdmin@ABCSecurity.com)  
Sent: Wednesday, October 07, 2009 8:33 AM  
To: JohnSmith@myhome.com  
Subject: Fire Alarm Message

The John's Home System has a **\*\*Fire Alarm\*\*** on the Hall Smoke Alarm.  
Message sent at: 8:31 AM

From: John's Home System (mailto: AlarmAdmin@ABCSecurity.com)  
Sent: Wednesday, October 07, 2009 9:01 AM  
To: JohnSmith@myhome.com  
Subject: Check-in Message

Cindy H has checked in at the John's Home System.  
Message sent at: 9:00 AM

From: John's Home System (mailto: AlarmAdmin@ABCSecurity.com)  
Sent: Wednesday, October 07, 2009 10:05 AM  
To: JohnSmith@myhome.com  
Subject: System Message

John's Home System has an AC Power Failure.  
Message sent at 10:02 AM

## MyAccess™ Text Messaging Commands

Your system may be programmed to allow simple text messages to be sent to the security system to perform basic user operations. By texting a message from your cell phone or PDA, the following actions can be performed: Arm/Disarm, Cancel Alarm, turn Outputs On/Off, check Armed Status, Turn Lights On/Off, Lock/Unlock Doors, and Set Thermostat.

The user that is texting commands to the system must have the authority to perform the commands as if it occurred at the keypad. The cell phone number and user numbers are setup during programming.

After programming is completed, you will receive a welcome message text from the panel. Write down the phone number that the message comes from. This will be the number you use to text user operations to the system.

**Note:** When texting commands listed below, the commands can be either upper or lowercase.

A list of In Touch™ SMS Text commands can be obtained by texting "help" to the system phone number. Store this number in your cell phone and write the number on the Quick Reference Wallet Card located at the back of this manual.

### Arming All Areas with Text Message Commands

1. Text message your system panel with the following command:
  - ARM, AWAY, or ALL: To arm all areas, depending on your system

### Arming Partial Areas with Text Commands

1. Text message your system panel with the following command:
  - SLEEP: To arm the perimeter and interior of a Home/Sleep/Away system.
  - HOME: To arm just the perimeter of a Home/Away/Sleep system.
  - PERIM: To arm the perimeter of an All/Perimeter system.
  - ARM "Area Number" or ARM "Area Name": To arm specific areas of an Area system.

The NAME should identify the area name. The NUMBER should identify the area number. Names and numbers can be mixed. A comma should be used to separate areas. If only ARM is sent, all areas are armed.

If the system is already armed, you can arm it again only if you are arming more areas than were originally armed.

### Disarming All Areas with Text Message Commands

1. Text message your system panel with the following command:
  - DISARM: To disarm all areas.

### Disarming Partial Areas with Text Message Commands

1. Text message your Area system panel with the following command:
  - DISARM "Area Number" or DISARM "Area Name": To disarm specific areas of an Area system.

The NAME should identify the area name. The NUMBER should identify the area number. Names and numbers can be mixed. A comma should separate the areas. If only DISARM is sent, all areas will be disarmed.

If the system is already disarmed, you will receive a message saying the system is already disarmed.

### **Cancelling an Alarm with Text Messaging**

While the alarm bell or siren sounds, you may choose to cancel the alarm via text messaging.

1. If a valid alarm has not occurred, text **CANCEL** to disarm the system and cancel the alarm.

### **Turning Outputs On/Off/Momentary with Text Messaging**

Allows you to set the state of any output to on, off, or momentary.

1. To set the Output to ON Steady, text **ON** followed by the Output name or number. For example, to turn Output 3 on, you would text: **ON 3** or **ON LIGHTS**.
2. To turn the Output to OFF, text **OFF** followed by the Output name or number. For example, to turn Output 3 off, you would text: **OFF 3** or **OFF LIGHTS**.
3. To turn the Output to ON MOMENTARY (the output turns on for one second, and then off), text **MOMENTARY** followed by the Output name or number. For example, to turn Output 3 to momentary, you would text: **MOMENTARY 3** or **MOMENTARY LIGHTS**.

### **Turning Lights On/Off with Text Messaging**

Allows you to turn Z-Wave compatible lights on or off.

1. To turn a specific light on, text **TURN ON** followed by the light name. For example, to turn Bedroom Light on, you would text: **TURN ON BEDROOM LIGHT**.
2. To turn a specific dimmer light on to a certain level, text **TURN ON** followed by the light name and the dimmer level (1-10). For example, to turn Front Dimmer Light on to level 8, you would text: **TURN ON FRONT DIMMER 8**.
3. To turn a specific light off, text **TURN OFF** followed by the light name. For example, to turn Bedroom Light off, you would text: **TURN OFF BEDROOM LIGHT**.

### **Locking/Unlocking Door Locks with Text Messaging**

Allows you to lock/unlock Z-Wave compatible door locks.

1. To lock a specific lock, text **LOCK** followed by the lock name. For example, to lock the Front Door, you would text: **LOCK FRONT DOOR**.
2. To unlock a specific lock, text **UNLOCK** followed by the lock name. For example, to unlock the Front Door, you would text: **UNLOCK FRONT DOOR**.

### **Setting Thermostat with Text Messaging**

Allows you to set Z-Wave compatible thermostats with specific temperatures.

1. To set the thermostat to Cool or Heat with a specific temperature, text **SET** followed by the thermostat name followed by **HEAT** or **COOL** followed by the temperature. For example, to turn Main Thermostat on to **COOL** and 65°, you would text: **SET MAIN THERMOSTAT COOL 65**.
2. To set the thermostat to Auto with specific heat and cool temperatures, text **SET** followed by the thermostat name followed by **AUTO** followed by the high temperature and the cool temperature. For example, to turn Main Thermostat on to **AUTO** with temperatures of 80° and 60°, you would text: **SET MAIN THERMOSTAT AUTO 80 60**.
3. To set the thermostat fan to Auto or On, text **SET** followed by the thermostat name followed by **FAN** followed by **ON** or **AUTO**. For example, to turn the Main Thermostat fan on, you would text: **SET MAIN THERMOSTAT FAN ON**.

### **Activating Favorites with Text Messaging**

Allows you to activate a Favorite of Z-Wave compatible devices.

1. To activate a Favorite, text **ACTIVATE** followed by the Favorite name. For example, to activate the Favorite named House Lights, you would text: **ACTIVATE HOUSE LIGHTS**.



### **Check Armed Status Text Command**

Allows you to check the system armed status. If armed, the system will send a message stating the type of system you have followed by ON, such as ALL SYSTEM ON or HOME SYSTEM ON. If disarmed and no open zones, the system will send SYSTEM READY. If disarmed with open zones, it will send SYSTEM NOT READY followed by any open zones. A message of AC POWER TROUBLE will indicate when a power failure occurs. If in alarm or trouble, the system will send ALARM ON or TROUBLE ON followed by up to 3 zone names that are in alarm or trouble.

1. To receive the Armed Status, text: STATUS.

### **Check Status of Lights, Locks, and Thermostats Text Command**

Allows you to check the status of Z-Wave compatible lights, locks, and thermostats. The status shows which devices are currently on and any devices that are not responding

1. To receive the Status of Z-Wave compatible lights, text: STATUS LIGHTS.
2. To receive the Status of Z-Wave compatible locks, text: STATUS LOCKS.
3. To receive the Status of Z-Wave compatible thermostats, text: STATUS THERMOSTATS.

### **Subscribe to Text Messages**

Allows you to set which text messages you receive from the panel. When your system is programmed to allow text messages, you will automatically be subscribed to ALL as described below. To change your subscription status, follow the instructions below for desired messages.

1. Text the words SUBSCRIBE STATUS ALL to receive a text message for all arming and disarming occurrences in addition to any alarm.
2. Text the words SUBSCRIBE STATUS NONE to not receive a text message for arming and disarming occurrences, but still receive a text message for any alarm.
3. Text the words SUBSCRIBE STATUS OTHERS to receive a text message for all arming and disarming occurrences originating from other users, in addition to any alarm. This option will send a text message for all arming and disarming occurrences except for the ones you initiate at a keypad.
4. Text the word SUBSCRIBE to show the current subscription status and the available subscription options.

## Frequently Asked Questions

This section attempts to answer questions you might have regarding system operation.

Q. If I bypass an exit delay door when I arm the system, will I get an alarm if I come through it later?

A. You will not get an alarm from the door because it is bypassed, but if you happen to walk through a motion detector space or other armed door inside the premises an alarm activates.

Q. When I arm or disarm my Area system, ALL? NO YES displays. Does this mean all areas in the system?

A. Selecting YES arms or disarms all areas that are authorized for your user code.

Q. How do I create a schedule that starts at 8:00 AM on Monday and ends at 5:00 PM on Friday.

A. In the days of the week display, select MON (Monday). For the OPENING TIME?, enter 0 + 8 + 0 + 0 AM. For the CLOSING TIME?, at the MON – : AM PM display, select MON; this scrolls through the days of the week. Stop at the day you want the schedule to end. Next, enter 0 + 5 + 0 + 0 PM into the FRI – : AM PM closing time display. Press COMMAND. Press the Back Arrow key to exit the User Menu.

This sets the opening time to 8:00 AM Monday and the closing time to 5:00 PM Friday. You can substitute any other day or time in this. What do I do if I want to be in the building past the scheduled closing (arming) time?

A. If your system is programmed for closing check, the keypad emits a steady tone prior to the system arming. During this tone, press any Select key to display ENTER CODE: . Enter your user code and press COMMAND.

The keypad now displays 2HR 4HR 6HR 8HR. Select the number of hours to extend the schedule. If the system is not armed by the scheduled closing time, a Late to Close report is sent to the central station. If the schedule is extended, a Schedule Change report may be sent to the central station.

## Common Keypad Displays

Listed below are several keypad messages you may see on the display. Follow the instructions in the Possible Solutions column to correct the problem. In many cases, you need to call a service person to correct the problem. Displays that are not discussed here mean that your service representative should be called.

| Message         | Meaning  | Possible Solutions   |
|-----------------|--|--|
| INVALID AREA    | The user has attempted a door access for an area they are not assigned.  | Change the user access areas if access to the area is needed. If access is not needed, the user cannot enter the area.                                   |
| INVALID CODE    | The user code you entered is not recognized by the system.   | Check the user code and try again.   |
| INVALID PROFILE | A user has attempted a function that is outside of the assigned profile.   | Check the user profile settings.   |
| INVALID TIME    | A user code assigned to a specific schedule has entered outside of the valid schedule.   | See Schedules and User Codes.  |
| ENTER 2ND CODE  | The area you are attempting to disarm or access is a Two Man Area.   | A second and different user code must be entered.  |
| CLOSING TIME    | The scheduled has expired but the area has not been armed.   | Users still on the premise should arm the system or extend the schedule to a later time.   |
| LATE TO CLOSE   | The system was not armed at its scheduled closing time.  | Users still on the premise should arm the system or extend the schedule to a later time.   |
| FAILED TO EXIT  | A user assigned the anti-passback option has attempted to re-enter an area from which they did not exit properly.                            | The user must exit the area through the proper door. If not possible, your system administrator should select the Forgive option in the User Codes menu. |
| ZWAVE BUSY      | Only one keypad at a time can access Z-Wave Setup. If a user attempts to access the menu from a second keypad Z-WAVE BUSY will be displayed. | The user must exit Z-Wave Setup in one keypad before accessing it in a second keypad.  |

# Index

## A

- Access Schedules 39
- Alarm Silence 19, 21, 25
- Alarm Verify 19, 21
- All/Perimeter System
  - Alarm Silence 19
  - Arming 18, 74
  - Disarming 19, 74
  - Shortcut Keys 18, 23
  - User Code 42
- Anti-Pass Back 10
- Anti Pass No 39
- Aqualite™ Keypad 3
  - Panic Keys 5
- Area Names and Numbers Record 53
- Areas 11, 16
- AREA LATE! 45
- Area System
  - Arming 16
  - Disarming 17
- Armed Areas
  - Checking 16
  - Display 26
- Armed Status 12
- Arming 11, 14, 16
  - All/Perimeter System 18, 74
  - Area System 16, 73
  - Bypassing Zones 14
  - Home/Sleep/Away System 20, 74
  - Key Fob 15
  - Quick Arming 16

- Selective 14
- Shortcut Keys 18, 20
- System 16

## B

- Back Arrow (<—) Key 6
- Brightness 7
- Browser 13
  - Add User Codes 43, 66
  - Add User Profiles 38
  - Bypass Zones 34, 65
  - Change User Codes 43, 66
  - Change User Profiles 38, 68
  - Delete User Codes 44
  - Delete User Profiles 38, 69
  - Output Group 69
  - Output On Off 27, 70
  - Zone Monitor 35, 66
  - Zone Status 34
- Bypass Zones 14, 34
  - Browser 65

## C

- Cancel Alarm 19, 21, 77
- Card Plus PIN (XR500E) 51
- Central Station Monitoring 11
- Clear Touch™ Keypad
  - Panic Icons 5
- CLOSING TIME! 45
- COMMAND 6, 7, 16, 17, 18, 22, 23, 25, 26,  
27, 28, 29, 30, 31, 32, 33, 34, 35,  
36, 37, 38, 39, 42, 43, 44, 45, 46,

47, 48, 49, 50, 60, 74, 80

## D

- Data Entry Keys 6
- Date and Time 49
- Disarming 11
  - All/Perimeter System 19, 74
  - Area System 17, 73
  - Card Reader 17
  - Entry Delay 74
  - Home/Sleep/Away System 21, 74
  - Key Fob 16
  - Quick 18
  - Selective 17
  - System from Keypad 17
- Display Events 49, 60
  - Arming and Disarming 61
  - Door Access 62
  - Schedule Change 63
  - System Monitor 63
  - User Code Change 61
  - Wireless Jamming 64
  - Wireless Trouble 64
  - Zone 61
  - Zone Bypass 61
- Door Access 11, 25, 62
  - Disarming 17
- Door Lock/Unlock 26
- Door Strike 73

## **E**

Easy Entry™ User's Guide 73  
Emergency Evacuation 2  
Entering User Names 71  
Entry Delay 74  
Entry Zone 12  
Event Displays 49, 60  
Exit Zone 12  
Extending Schedules 22

## **F**

Failure to Exit 44  
False Alarms 1  
Fault 12  
Favorite 23, 27, 28, 30, 31, 32, 45, 48, 55,  
77  
Favorites 23, 30, 41, 45, 48, 55, 77  
Fire Drill 50  
Forgive Failure to Exit 44

## **H**

Holiday Date  
Record 59  
Home/Sleep/Away System  
Alarm Silence 21  
Arming 20, 74  
Disarming 21, 74  
Shortcut Keys 20, 23  
User Code 42  
How Your System Operates 14

## **I**

Instant Arming 19  
Instant Zone 12

*Index*

## **K**

Keypad  
2-Button Panic Keys 5  
Common Displays 81  
Displays 10  
Key Definitions 6  
LEDs 4  
Multi-lingual Display 6, 23  
Select Keys 4  
Shortcut Keys 22  
Tones 8  
Types 3  
User Menu 1  
User Options 6, 7  
Wireless Displays 9  
Key Fob 9, 52  
Arming 15  
Button Layout 9  
Disarming 15  
LED Operation 72  
User Record 52

## **L**

LCD Keypad 1  
LED Operation 4, 5, 72  
Lockdown 25

## **M**

Monitoring 11  
Multi-lingual Display 6, 23  
MyAccess 11

## **O**

Options 7

Outputs On Off 26  
Browser 70  
Output Groups  
Browser 69  
Output Relay Record 59

## **P**

Pager Direct™ 74  
Panic Zone Test (XR500 Series) 36  
PIN (XR500E) 42  
Power LED 4, 5  
Profiles 37  
Adding 37  
Changing 38, 68  
Chart 41  
Deleting 38, 69  
User Profile Record 56

## **Q**

Quick Arming 16  
Quick Disarming 18

## **R**

Re Arm Delay 39

## **S**

Schedules 17, 45  
Door 45  
Extending Schedules 11, 22  
Holiday (HOL) 45  
Output (OUT) 45  
Record 58  
Setting Holiday ABC Schedules 47  
Setting Output and Door Schedules 47  
Setting Shift Schedules 46

- Security System Terms 11
- Select Keys 4
- Sensor Reset 25
- Service Request 49
- Shortcut Keys 18, 20, 22, 25, 34
  - Arming Function 18, 20, 22
  - Monitor (Chime) Function 23, 34
  - Sensor (Fire) Reset Function 23, 25
- Silence Alarm 25
- Status 12
- System Setup Record 51
- System Status 35
- System Test 1, 36

## **T**

- TEMP CODE 38
- Thinline™ Keypad 4, 5, 6, 8
  - LEDs 3
  - Panic Keys 5

## **U**

- User Codes
  - Adding 42, 66
  - Changing 43, 67
  - Deleting 44, 67
  - Names 42, 71
  - Numbers 42
  - Record 57
- User Disarm and Entry 10, 70
- User Menu Options 23
  - Alarm Silence 25
  - Armed Areas Display 26
  - Bypass Zones 34
  - Door Access 26

- Outputs On Off 26
- Sensor Reset 25
- System Status 35
- System Test 36
- Zone Monitor 34
- Zone Status 33
- User Options 7
- User Profiles 37, 42
  - Adding 37
  - Changing 38, 68
  - Chart 41
  - Deleting 38, 69
  - Record 56

## **V**

- Verify Alarm 19, 21

## **W**

- Wireless 9, 71
  - Jamming Event Display 64
  - Trouble Event Display 64

## **Z**

- Zone 12
- Zone Monitor 34
  - Browser 66
- Zone Status 13, 27
  - Browser 65
- Z-Wave 27, 28, 29, 30, 31, 32, 33, 41, 44, 45, 48, 77, 78
- Z-Wave devices 24, 27, 28, 29, 30, 31, 32, 33
- Z-Wave Favorite 27, 45, 48
- Z-Wave Setup 28, 81





LT-1278 © 2013 Digital Monitoring Products, Inc.



13515